

®

Design Line panic push bar for single and double leaf doors, in accordance with DIN EN 1125

Original assembly and maintenance instructions

Table of contents

Information about assembly instructions.....	Page 2
Description.....	Page 3
Areas of application.....	Page 3
Scope of supply: Panic push bar active leaf PZ 92.....	Page 4
Mechanical processing.....	Page 4
Assembly axle and rod length.....	Page 5
Square spindle length.....	Page 5
Assembly.....	Page 6
Performance check.....	Page 7
Related locks and fittings.....	Page 8
Important notes and safety measures.....	Page 9
Maintenance recommendation.....	Page 10
Documentation.....	Page 11

Information about assembly instructions

Date of issue:

January 2021

Copyright:

The copyright for these assembly instructions belongs to the manufacturer.

Manufacturer's address:

Wilh. Schlechtendahl & Söhne GmbH & Co. KG

Hauptstraße 18 - 32, 42579 Heiligenhaus

Telephone: +49 (0) 20 56/17-0

Fax: +49 (0) 20 56/51 42

Website: www.wss.de

Email: wss@wss.de

Description

Design Line WSS panic push bar for single and double leaf doors

Item no.: 14.4xx/4xx.0000.---

EC certificate of conformity:

1309-CPR-0304

Standard: DIN EN 1125:2008-04

Classification:

3	7	7	B	1	3	2	2	A	A/B/C
---	---	---	---	---	---	---	---	---	-------



This product serves to protect human life.

It is required that the safety features of this product are in compliance with the DIN EN 1125. With the exception of the changes described in these instructions, no further changes are permitted.

The main purpose of this product is to save human lives in the event of panic situations. Its most important feature is making it possible to open the door by applying only minimal pressure with the hand or body, even if, for example, darkness and smoke cause a crowd of people to panic and to put pressure on the door.

To ensure constant ease of operation, it is required that these assembly instructions are strictly followed, and that the fittings are assembled diligently and carefully by sufficiently qualified technical personnel.

After the assembly and function test, these instructions must be handed over to the user and/or operator. Assembly instructions must be available to the assembler/technical operator at all times. Additional copies can be requested.

Areas of application

All information on the temperature range and door features can be found in the current certificates for locks, multi-point locks and accessories:

WSS: 1309-CPR-304

Fuhr: 1309-CPR-422

Single leaf, DIN left side

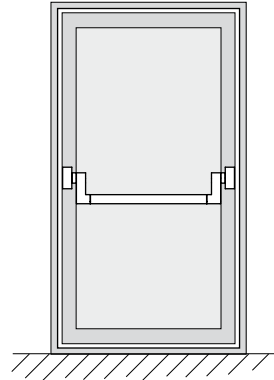

Double leaf, DIN left side

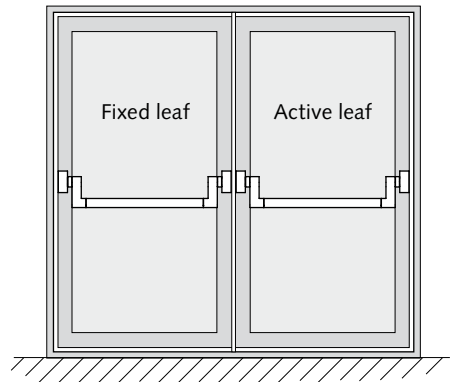

Scope of supply: Panic push bar active leaf PZ 92

- 1 Handlebar 1.200, 1x
- 2 Mounting piece, 2x
- 3 Levelling piece, 2x
- 4 Lever, left side
- 5 Functional unit, locking side, 1x
- 6 Lever, right side
- 7 Functional unit, hinge side, 1x
- 8 Cover cap, 2x

Please note:
The door manufacturer provides M5 hammer-head screws to fasten the fittings on the profile.

- Accessory pack, 1x, consisting of:
- 9 Threaded pin M6x12 TX 15, 2x
 - 10 Countersunk screw M5x9 TX 25, 2x
 - 11 Hammer-head screw M5, 4x
 - 12 Blind rivet nut M5, 4x

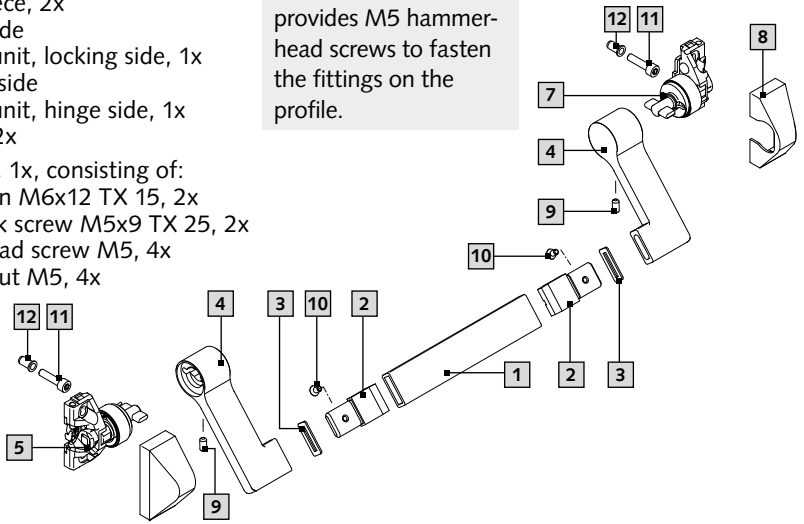

Mechanical processing

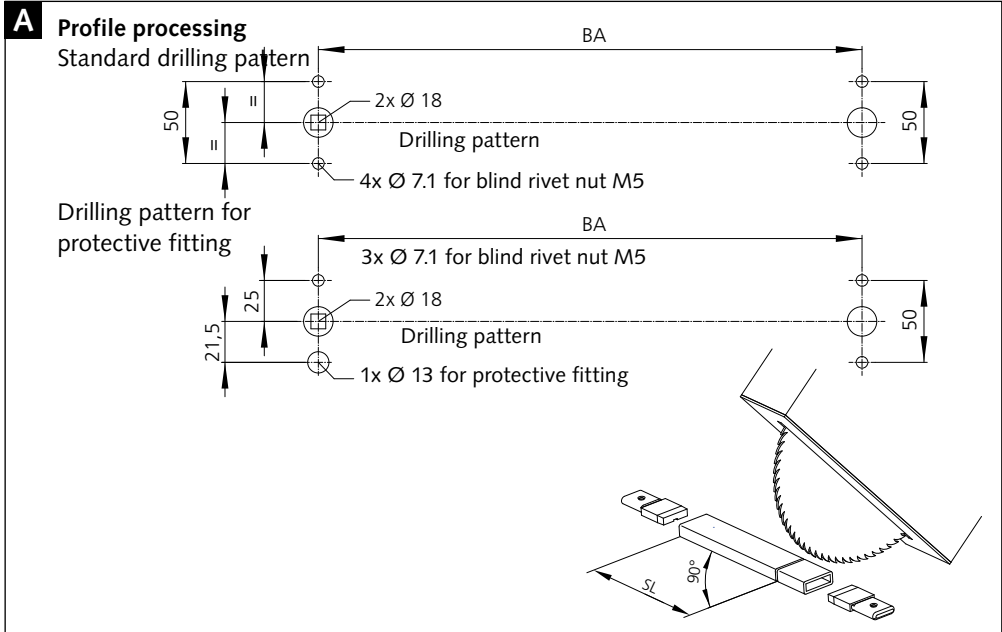

Assembly axle and rod length

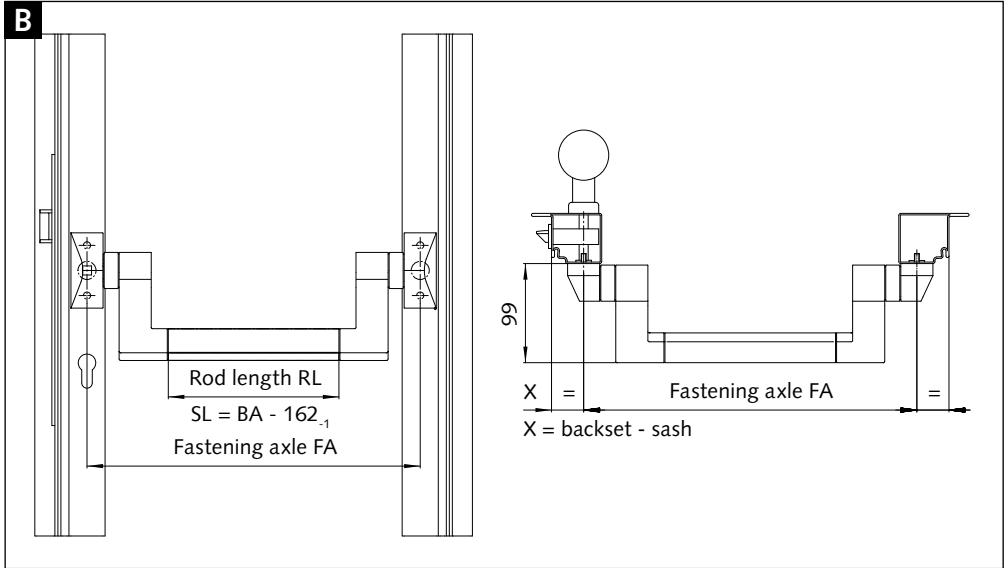

Square spindle length

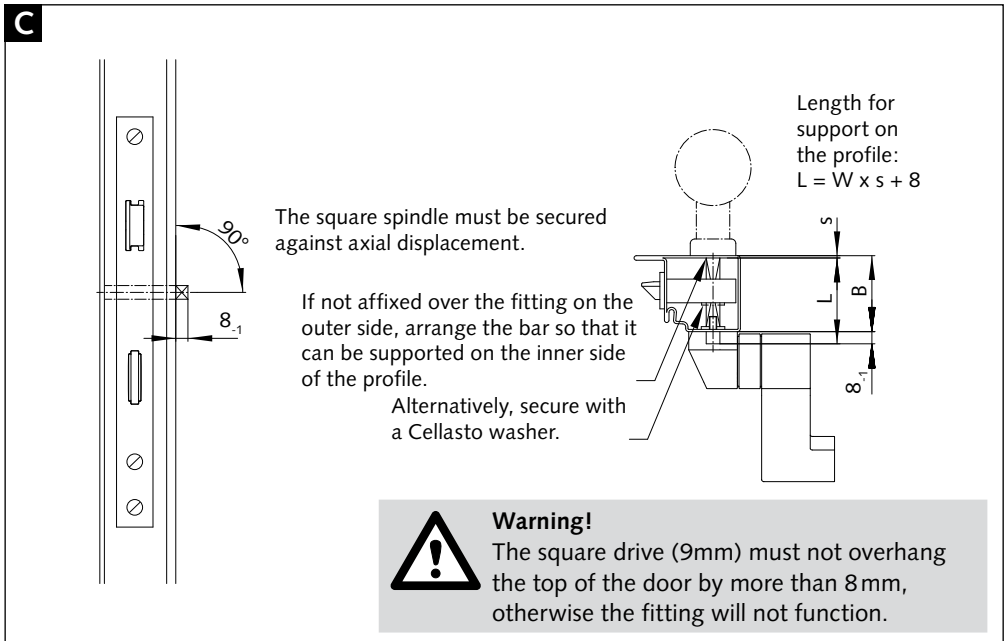

Assembly

The assembly steps found on the following pages refer to a single leaf door. The assembly

steps for a double leaf door (fixed leaf with lock keeper) are the same.

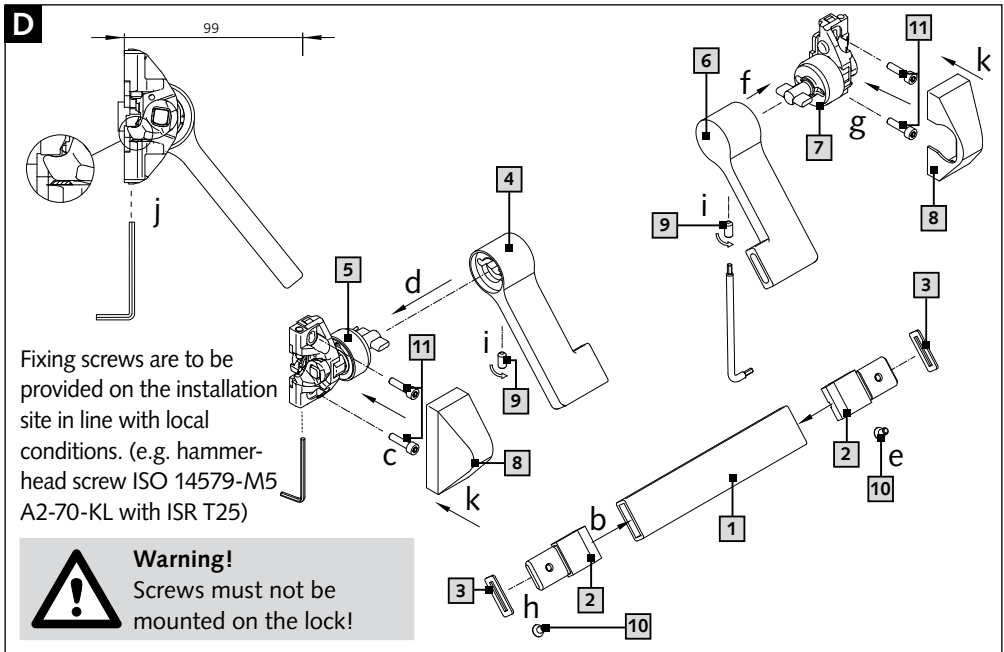

- a. Cut handlebar **1** to size. (Fig. A)
- b. Push levelling piece **3** onto the mounting piece **2** to the stop and then use a plastic mallet to hammer the mounting piece **2** into the handlebar.
- c. Affix the functional unit **5** to the casement profile using 2 screws **11**.
- d. Insert lever **4** into the functional unit **5**.
- e. Insert lever **6** into the handlebar **1** and screw into place with screw **10** (tightening torque 4 Nm).
- f. Insert lever **6** and handlebar **1** into functional unit **7**.
- g. Push the loose end of the handlebar **1** into the lever **4** and affix the functional unit **7** to the profile using 2 screws **11**.
- h. Screw the handlebar **1** and lever **4** into place using screw **10** (tightening torque 4 Nm).

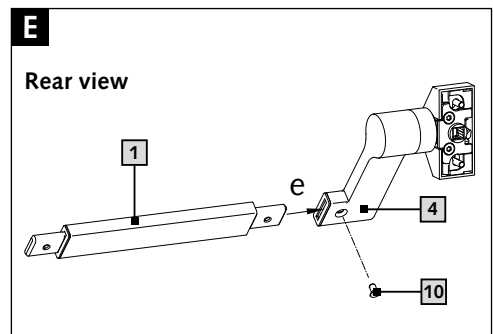

- i. Secure each lever with 1x threaded pin M6x12 **9** (tightening torque 3 Nm).
- j. Use a stop screw to set the rod overhang to 99 mm.
- k. Place cover caps **8** on the bearings (push as far as stop).

Performance check

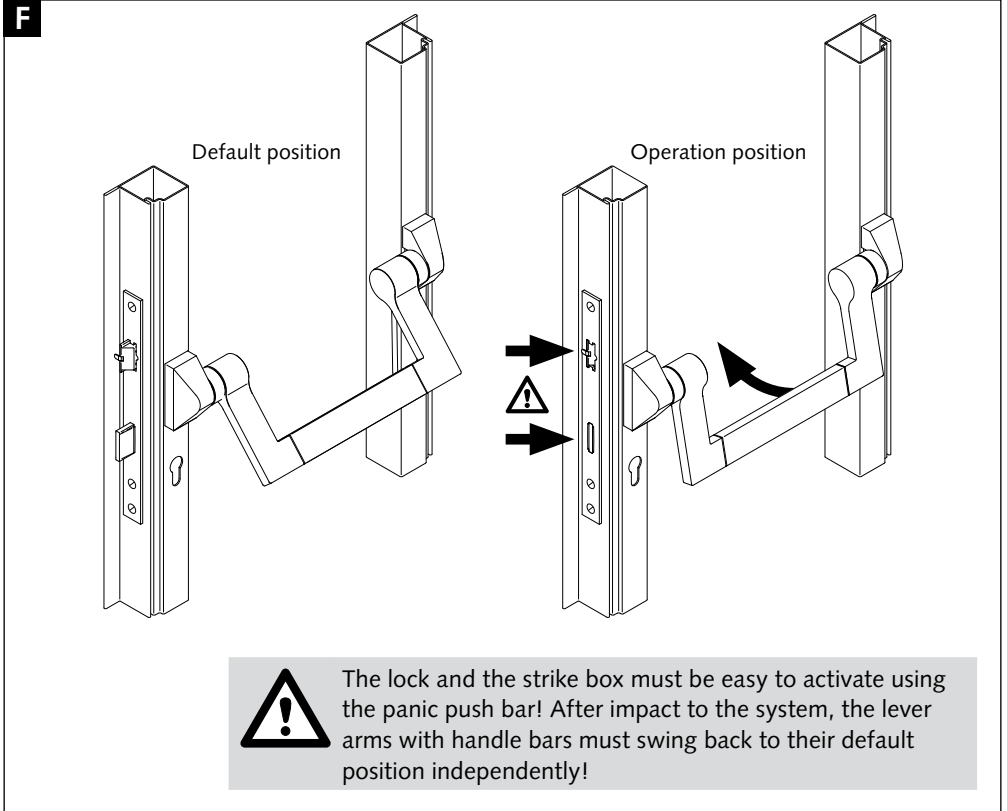

Note: Tension*

Narrow door widths and/or backsets can lead to tension in the area *. To avoid this, it is absolutely necessary to obtain a graphic outline from the door manufacturer in advance!

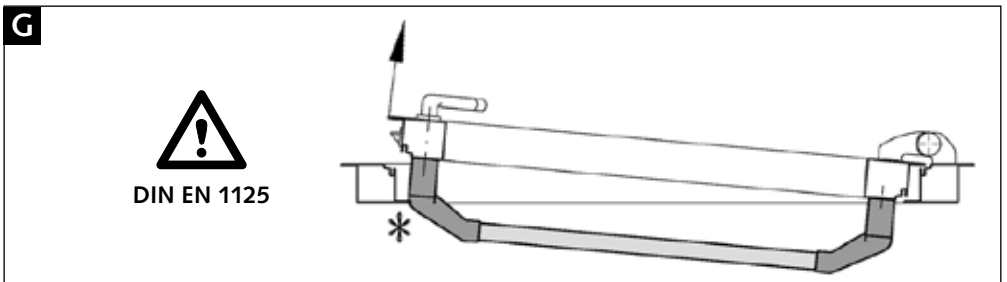

Related locks and fittings

The panic push bar can only be installed as an entire panic doorlatch in connection to the following products.

	WSS		Fuhr
	Sv panic	Panic	
Single leaf	Item no.: 14.250.xx 14.252.xx 14.260.xx 14.262.xx 14.270.xx 14.272.xx	Art. No.: 14.160.xx 14.162.xx 14.164.xx 14.172.xx 14.174.xx 14.176.xx	Multi-point locks, anti-panic counter boxes and accessories according to 1309-CPR-422
Double leaf	Item no.: 14.254.xx 14.256.xx 14.264.xx 14.266.xx 14.274.xx 14.276.xx	Art. No.: 14.166.xx 14.168.xx 14.170.xx 14.178.xx 14.180.xx 14.182.xx	
Fixed leaf	Panic strike box*: Item no.: 14.280.xx, 14.284.xx, 14.285.xx Switching lock: Item no.: 14.288.xx		

*Locking bar with accessories and striking plate, according to enclosed requirements.

The aforementioned items have their own respective assembly and operating instructions, which are to be followed.

It is forbidden to install additional or other fastenings, that are not included in the item listed above and/or not within the DIN EN 1125 standard, is forbidden, unless express permission from the responsible licensing agency has been obtained. This does not apply to the installation of door closers.

When used with products from Fuhr, the angle of rotation must be set as follows.

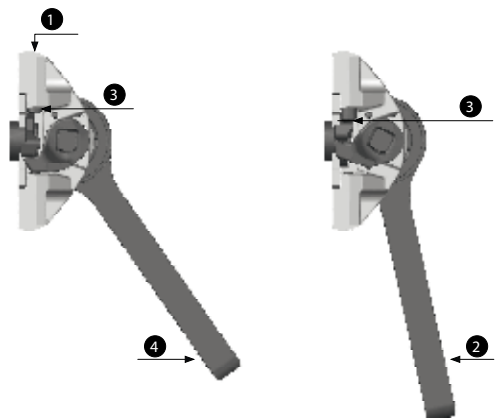

- 1 Turn back threaded pin M6 (both sides)
- 2 Push the anti-panic push-bar until it stops
- 3 unscrew in the threaded pin until it stops (both sides)
- 4 Basic position



Important notes and safety measures

- The aforementioned WSS products according to DIN EN 1125 ensure very high quality and safety standards. In order to maintain this high standard, the doors must be in perfect condition both during and after assembly. The door must be checked to make sure it opens correctly, easily and is unobstructed. It should display no signs of warping.
- Before the emergency exit/panic lock is installed in a fire or smoke protection door, it should be checked that the emergency exit lock is suitable and authorised to be used for that particular door (see attachment B, DIN EN 1125).
- When putting on file and door seals, it must be ensured that these do not impair the proper operation of the door and/or the functioning of the emergency exit/panic lock.
- On double leaf doors with centered overlap, on which both leaves are equipped with emergency exit/panic locks, each door must open when its lock is activated. It must be ensured that the door leaves and fittings are free of tension. If necessary, a pushing flap is to be used.
- For panic locks in accordance with DIN EN 1125, it must be ensured that the correct length is mounted. The most effective possible rod length is to be chosen; at least 60% of the door's width must still be free.
- Doors with glazed panels which are equipped with an emergency exit/panic lock should be equipped with safety glazing (safety glass or laminated safety glass).
- When mounting an emergency lock on different types of doors, different mounting parts are required. which differ from those included in the items supplied. In this case, the installer should choose a durable, solid fastening in accordance with requirements, or should consult WSS.
- Emergency locks are not suitable for use on swing doors, unless they were manufactured specifically for that purpose.
- The handle or the panic push bar/panic pressure bar should normally be installed at a height of between 900 mm and 1100 mm above finished floor level. If it is known that the majority of users will be small children, a reduction in the height of the handle should be considered.
- The latch, bolt and locking bars should be installed and secured in such a way that safe action is guaranteed. It should be ensured that, when in the closed position, the overhang does not prevent the door from moving freely.
- If the emergency exit/panic locks to be mounted onto double leaf doors have been provided with rebated half-overlay and door closers, a door selector in accordance with DIN EN 1158 with pushing flap should be installed, or a latch sequence control integrated into the locking system, in order to ensure the correct closing sequence. This recommendation is particularly important for fire and smoke protection doors.
- If a door closer is installed, it must be ensured that this does not make it unnecessarily harder for children, handicapped persons and elderly persons to operate the door.

- Any provided floor locking troughs, striking plates and/or locking troughs should be installed according to the instructions, so that they conform with the certified standard. Deviations due to different door profiles determined by the system are only allowed in consultation with WSS.

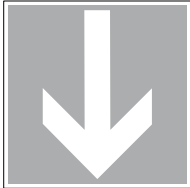

On panic doors according to DIN EN 1125, there should be a sign on the inner side of the door, directly above the horizontal activation bar or on the activation bar itself, which says 'Push' or 'Push bar to open', or there should be a pictogram demonstrating this. The colour should be white

on a green background, similar to the pictogram Picture A1 in the DIN EN 1125 (point A.19).

- The panic function is only guaranteed when the key is pulled out.
- The use of knob cylinders in connection with the panic push bar is not permitted, as this would present a danger of fingers being trapped.

Maintenance recommendation

The following ongoing maintenance is to be carried out by the operator or by a third party commissioned by the operator, at intervals of no more than a month:

- Inspection and activation of the emergency lock, in order to make sure that every part of the lock is in perfect condition.
- Additionally, a force measurement is to be taken at least once a year. With a dynamometer (pressure box etc.), the actuating force required to activate the emergency escape door lock is to be measured and recorded.
- It must be checked and/or ensured, that the latch, bolt and locking bars are not blocked.
- It is to be checked that the door/s is/are easy to open and is/are unobstructed, and there must not be any signs of warping.
- It must be ensured that all screws are firmly tightened, and that all parts of the emergency exit/panic lock are mounted properly.
- Using these instructions, the fittings components must be checked for completeness.
- It must also be checked that no additional locking devices were attached after assembly, as this could lead to an impairment of the panic function (e.g. kicking the door holder...).
- Make sure that all locking pieces are completely enclosed, and that the contact areas of the latch on the striking plate and the locking bar in the locking components are well oiled.

Documentation

Handover report of the function check for the initial commissioning

Door number	Tester	Date	Signature

Documentation of maintenance

	Door number	Tester	Date	Signature
1				
2				
3				
4				
5				
6				
7				
8				
9				
10				
11				
12				



Wilh. Schlechtendahl & Söhne
GmbH & Co. KG

Hauptstrasse 18–32
42579 Heiligenhaus
Germany

Phone: +49 (0) 20 56/17-0
Fax: +49 (0) 20 56/51 42

wss@wss.de
www.wss.de