

Assembly sequence of the link rods

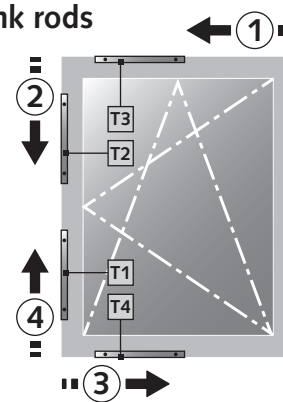

Installation drawing (drawing shows DIN right)

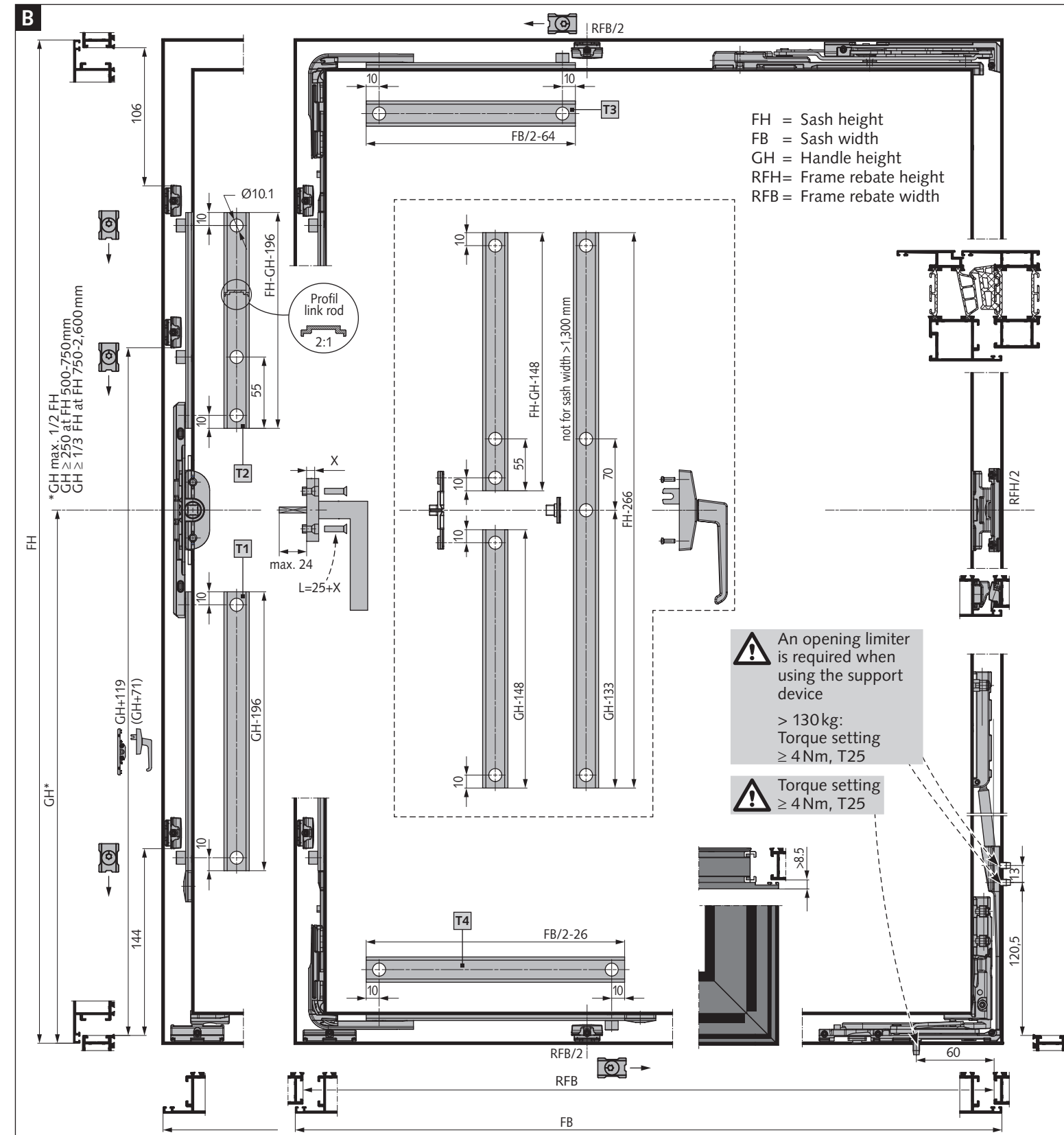

④

Assembly Instruction Style 180°: Turn Fitting

General information

This assembly instruction is a component of the product. It contains important details on safety, installation and use. This instruction is intended for specialist personnel. Use the product only as described and for the areas specified of application. After installation and function test, this instruction must be handed over to the user or operator. It must be kept for future reference.

Part description (fig. A)

Basic fitting scope of delivery

- 1 Tilt bearing
- 2 Sash ramp
- 3 Pluggable locking pins
- 4 Striker
- 5 Ramp frame
- 6 Corner transmission without mishandling device
- 7 Turn bearing, frame groove 10-12 or >12-14 mm
- 8 Turn hinge
- 11 Corner hinge
- 12 Corner bearing, frame groove 10-12 or >12-14 mm
- 13 Special self-tapping screw

Accessories (fig. A)

- 14 Support Device >130kg, complete
- 14.1 Frame block incl. screws
- 14.2 Support plate

Vertical centre locking:

- 22.2 Locking point, 1x
- 22.3 Striker, 1x
- 22.4 Frame bracket, 1x
- 22.5 Sash bracket, 1x

Gear handles:

- 23 Concealed gear with or without mishandling device
- 24.1 Gear handle
- 24.2 Drive connector, one piece, including screws
- 24.3 Drive connector, separable, including screws
- 25 Stroke limiter 90°

Third-party parts (fig. B)

- T1-T4 Link rods

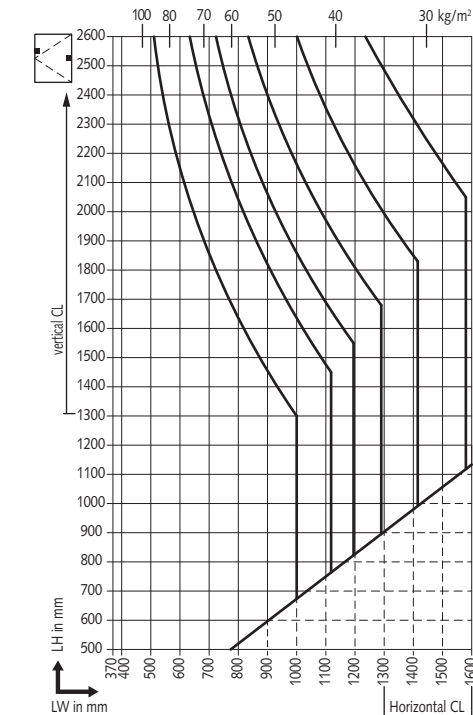

Application diagram up to 130kg

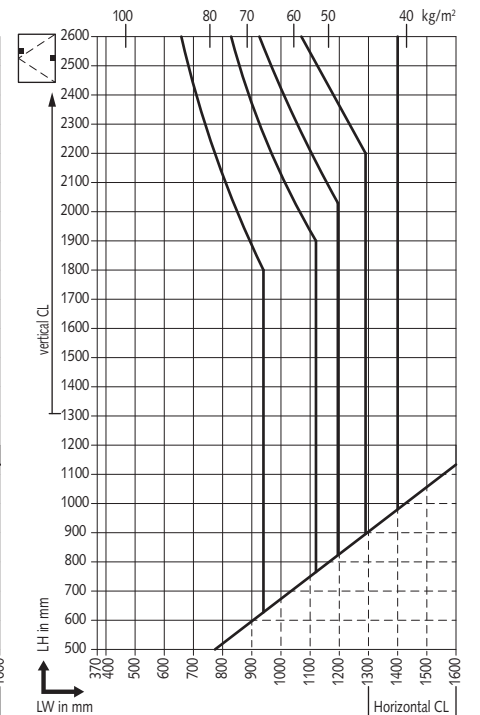

Application diagram up to 170kg

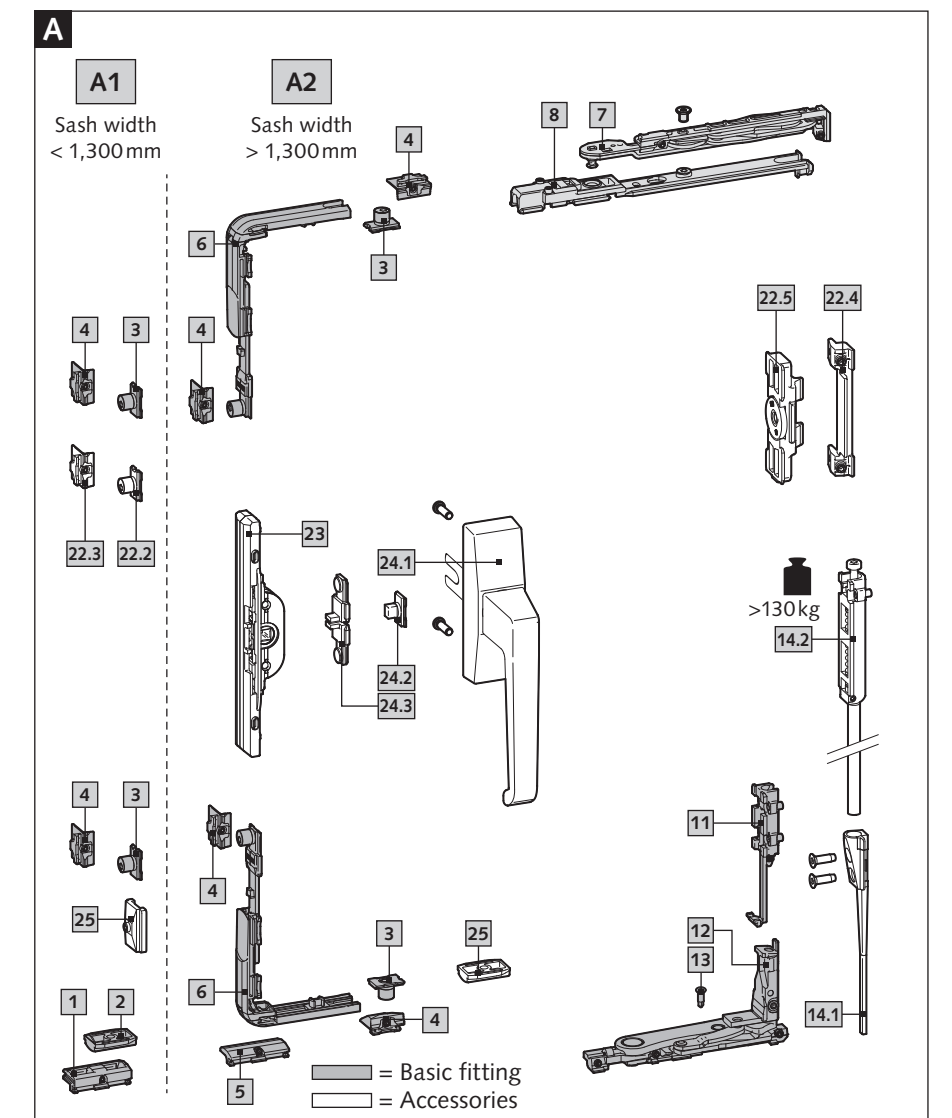

Assembly instructions, frame

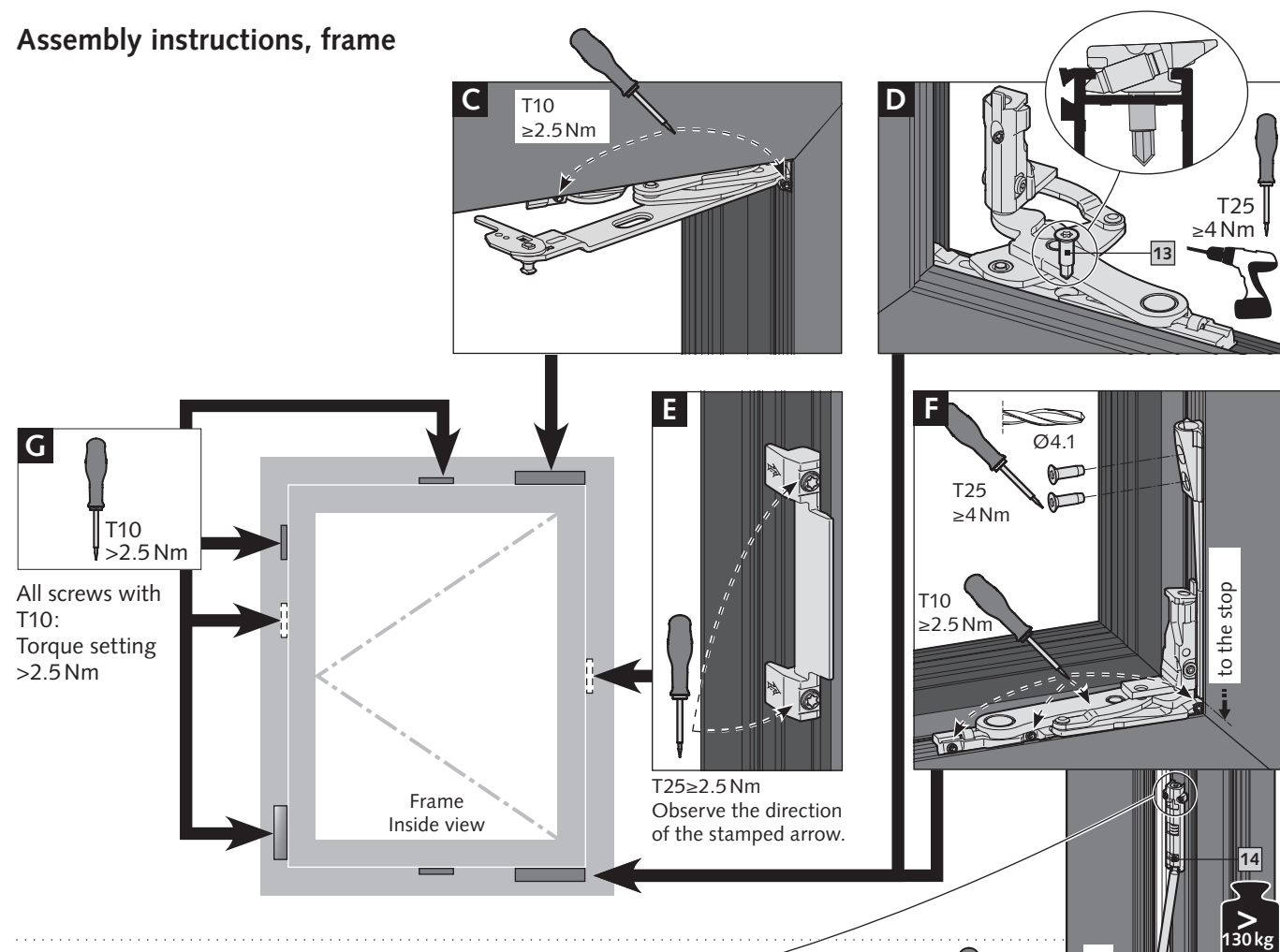

Assembly instructions, sash

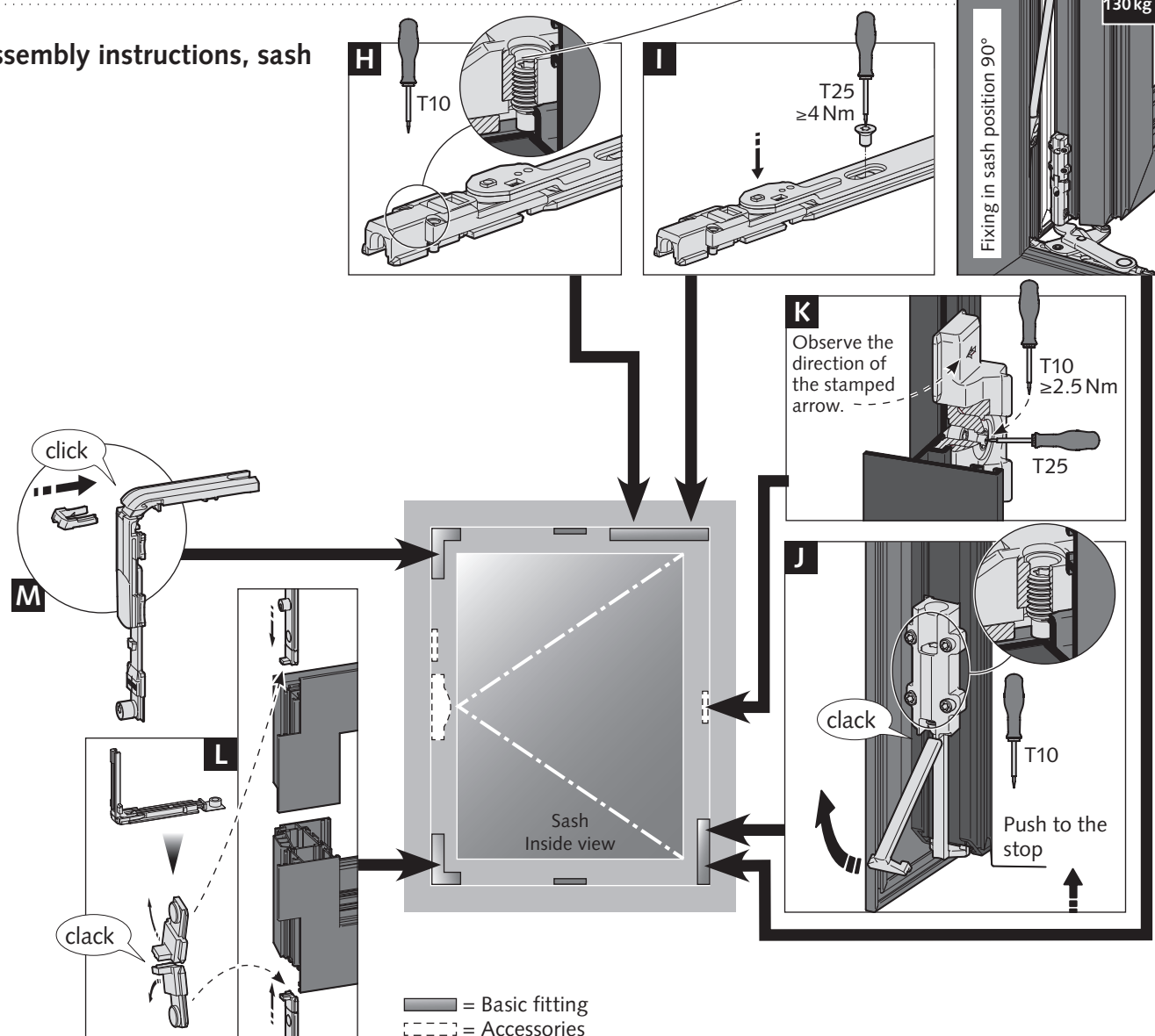

! Important information

- The support device **14** must be used for sash weights >130 kg.
- It is essential to use a stop or opening limiter style 180° when using the load transfer >130 kg (no fig.)
- From a window width or -height of 1,300 mm, we recommend the use of additional locking systems.
- When installing the fitting parts, the torques setting must be considered (see figures).
- Only a combination of original WSS parts may be used.
- The use of opening limiters is recommended when window sashes can knock against the window reveals or aluminium support profiles in an uncontrolled manner (e.g., caused by wind) that the profiles can be damaged or destroyed.
- With side adjustment of the hinges / bearing, it is necessary to readjust the centre locking on the hinge side.

Tool selection

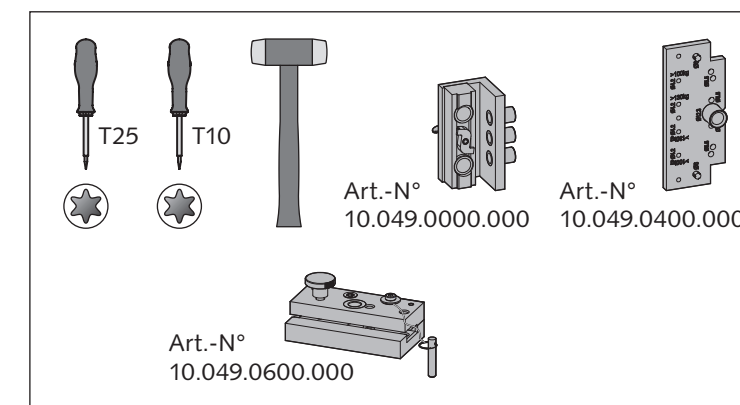

Profile processing

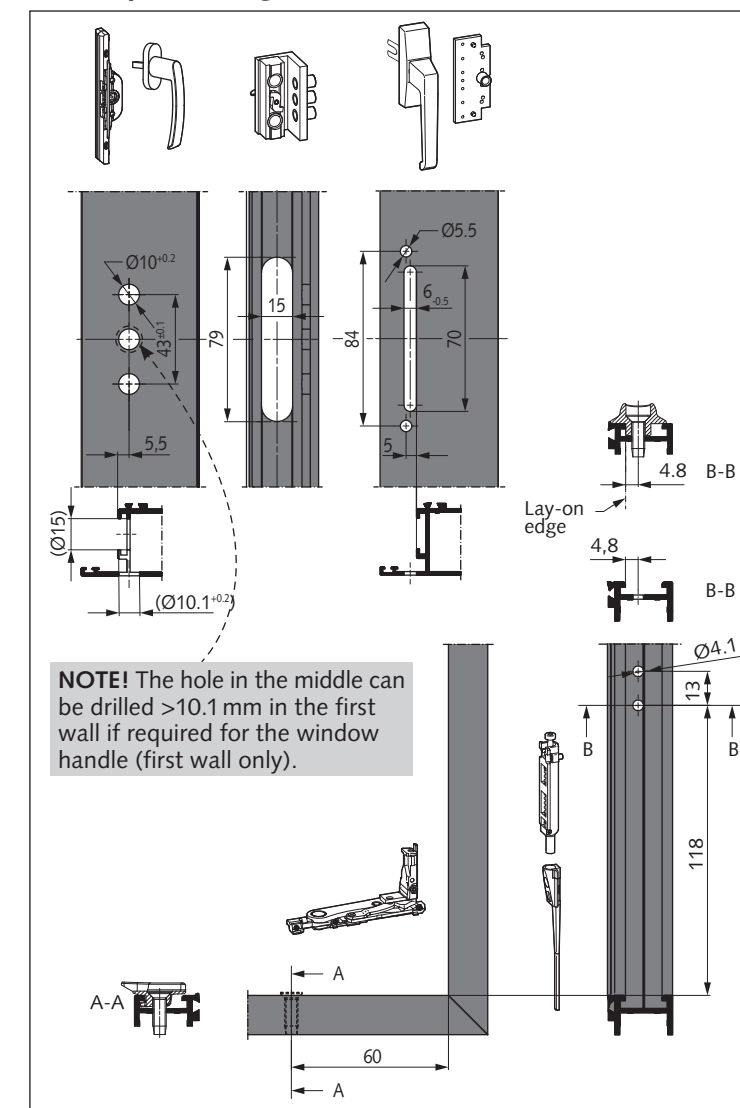

Installation of the sash

1. Put the locking side in turn position.
2. Bottom corner bearing: position the sash and screw the corner hinge to the corner bearing (fig. N).
3. Install and screw the turn hinge and turn bearing. Put the support in the locked position (fig. O)

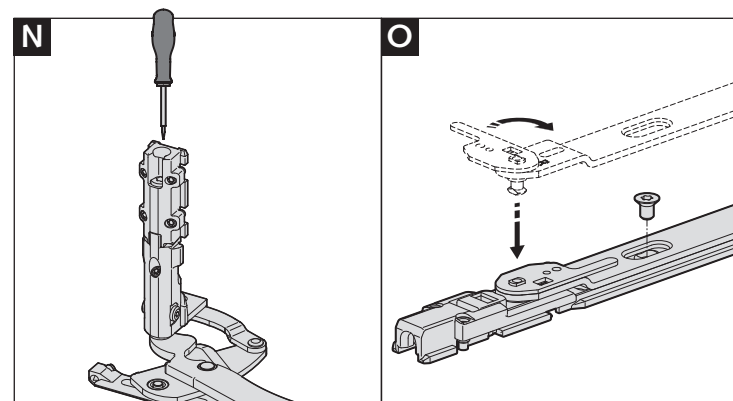

Adjustment

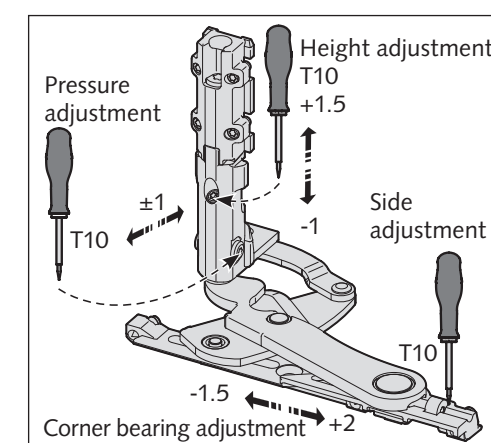
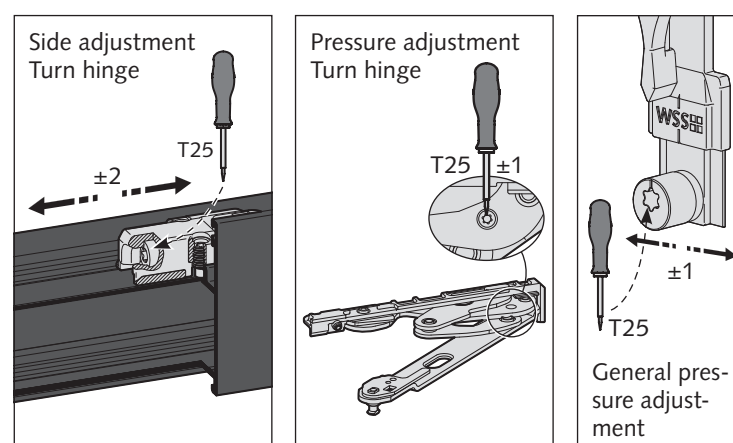
WSS 

Wilh. Schlechtendahl & Söhne
GmbH & Co. KG
Hauptstrasse 18-32
42579 Heiligenhaus
Germany
Phone: +49 (0) 20 56/17-0
Fax: +49 (0) 20 56/51 42
wss@wss.de
www.wss.de