

General information	
■ Frequently asked questions (FAQ)	460
■ Stainless steel handles on request	461
Push/Pull handles	
■ Stainless steel	462
■ Aluminium	462
■ Brass	462
■ Glass	479
Handles with console	
■ Stainless steel	481
■ Aluminium	483
■ Glass	485
■ PVC	486
■ Wooden	487
■ Bronze	488
Hollow-profile/wooden handles	
■ Stainless steel	489
■ Aluminium	489
■ Wooden	490
Hollow-profile/consols	
■ Aluminium	491
■ Accessories	494
Glass holders	
■ Technical product information	495
■ Zinc die casting	496
■ Aluminium	499
■ Brass/Stainless steel (V2A)	501
■ Stainless steel (V4A)	502
Hand rail supports	
■ Rotatable support	505
■ Fixed support	505
Hand rail systems	
■ Plug connection system (modular)	507



1



2



3



4



5



6



7



8



9

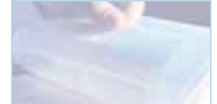

i



Get a grip.

Handles made from various materials.

- available in stainless steel, brass, aluminium, glass, PVC and bronze
- pipe diameters from 20 mm to 50 mm
- comfortable surface by elaborate grinding

► [Products see page 462 and following](#)

Due to elaborate grinding for all materials, these handles show and comfortable haptic.

Holds glass, holds tight.

Glass holder with straight and arched plating.

- available in zinc die casting, light alloy, stainless steel and brass
- all glass holders with TÜV-testing label
- with straight and arched plating
- with security pin
- with stainless steel clamping screws

► [Products see page 496](#)

The included security pin provides additional support of the glass.

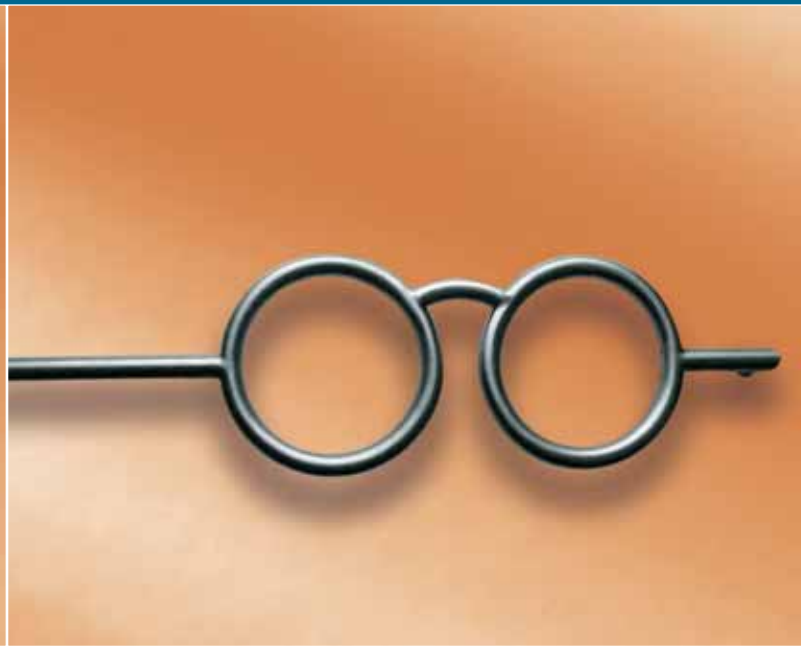

Modular and individual.
Hand rails as plug connection system.

- modular system for individual design of hand rails
 - pipe-diameter from 35 mm up to 42,4 mm
 - completely pre-grinded
 - with hand rail supports
- [Products see page 507](#)

The pre-grinded modules make the single welding of each part unnecessary.
The installation is very easy and long lasting.

Made by measure if desired.
Special versions of handles and hand rails.

- acc. to customer's drawing
 - within a couple of working days
 - complete handrail systems also available
- [Products see page 461](#)

Due to the special surface quality we recommend stainless steel handles and hand rails for exterior areas.

1

Frequently asked questions (FAQ).

2

3

4



- **Which distance does the measurement of the axis concerning the door handles describe?**

The measurement of the axis describes the distance between two fixing points.

- **What is the material of WSS stainless steel handles?**

Normally, the handles are made out of V2A No. 1.4301 stainless steel. On request we can also use V4A stainless steel for handles.

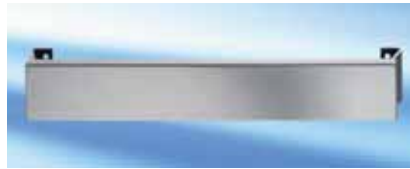

5

- **Is it allowed to fix handles back-to-back through smoke-/ fire-resistant doors?**

No, it is not allowed. The fixing must be done one-sided with pop rivet nut M8.

6

7

8

9

i

Stainless steel handles on your desire

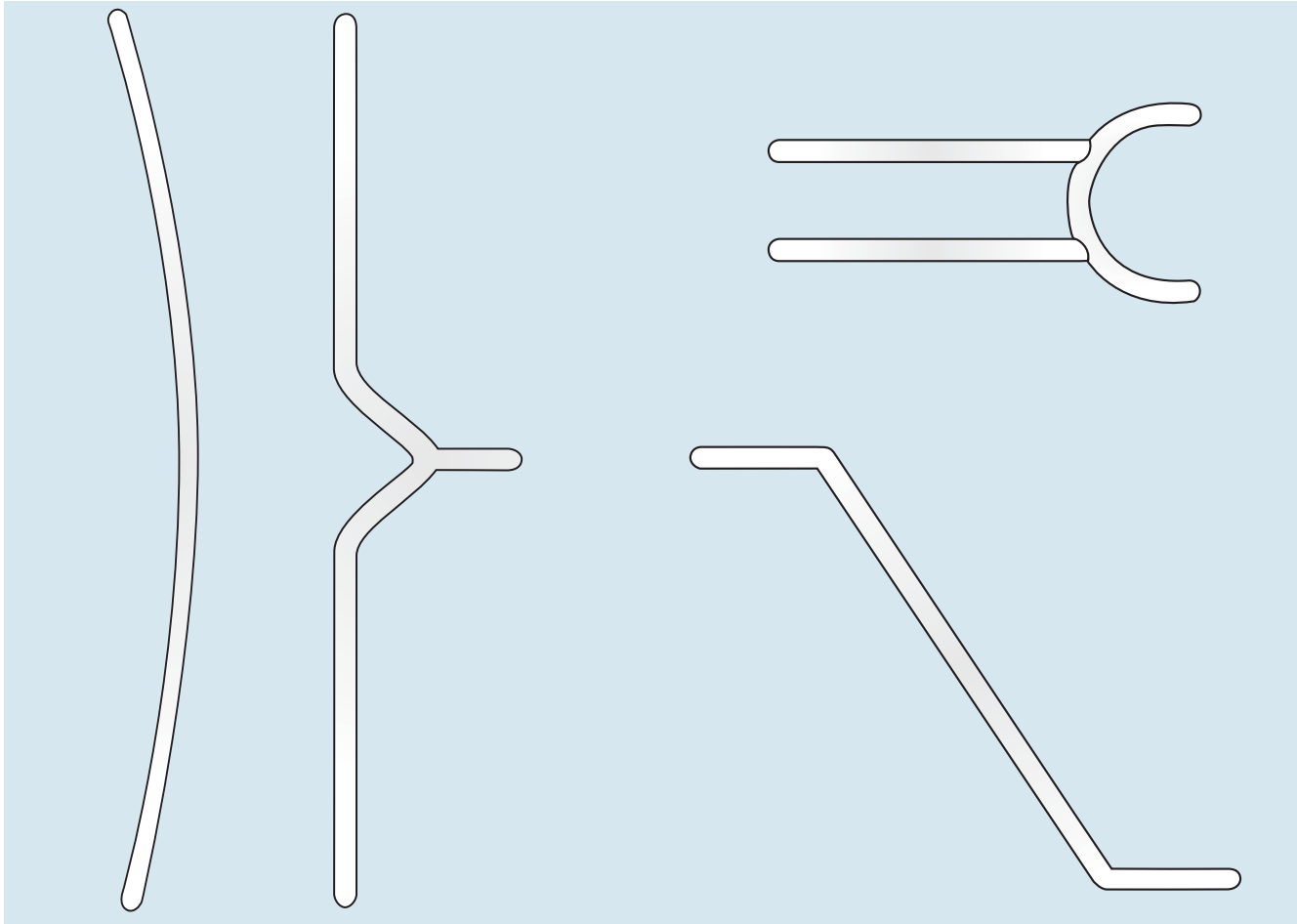

With us you can realize your own „designer-handle“. Please send us your idea as a layout or a detailed

drawing and we will produce the handle, as wished!!

Do you need any help or information?
We look forward to receive your call.
Telephone: +49-20 56 / 17-0

Additional pipe endings for stainless steel handles, 30 mm diameter

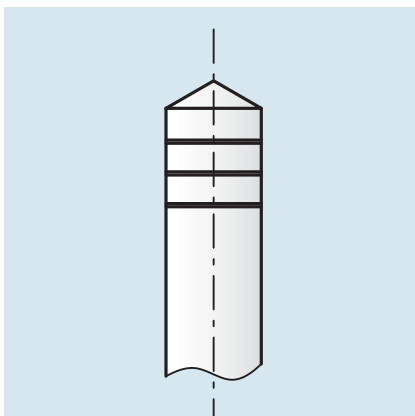

Version 1

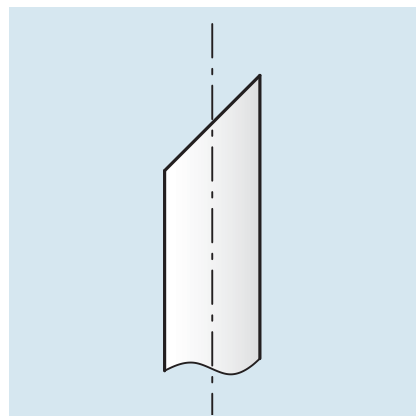

Version 2

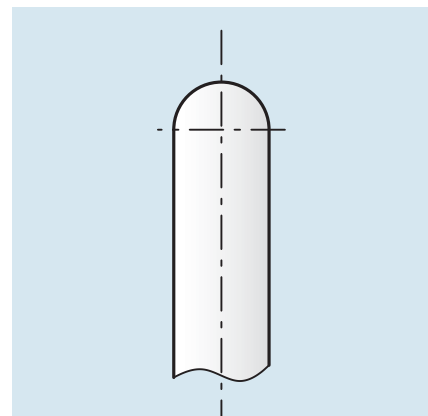

Version 3

1

2

3

4

5

6

7

8

9

i



1

2

3

4

5

6

7

8

9

i

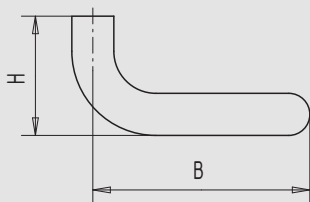
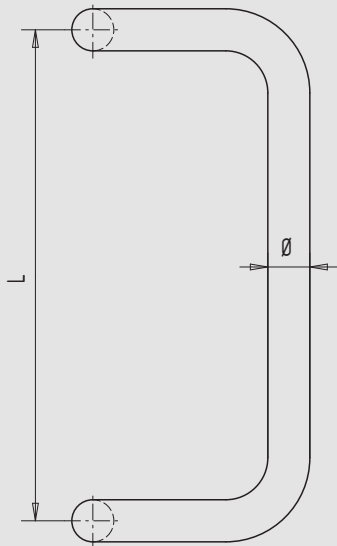
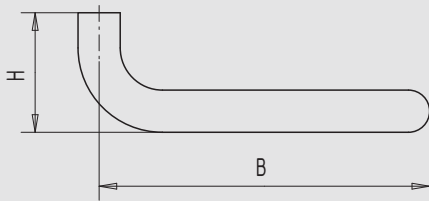
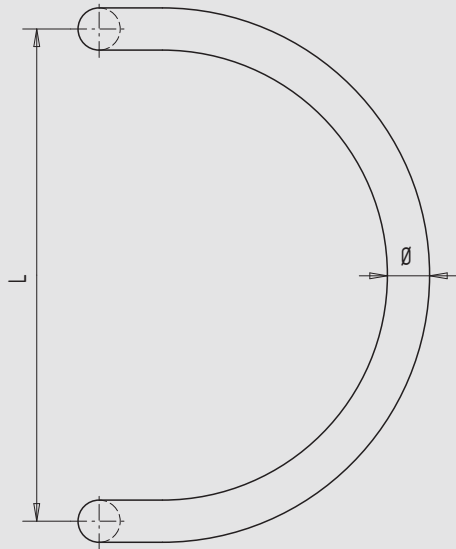

Handle

- stainless steel
- aluminium
- brass

Art.-no.	Ø	L	H	B
08.100.2520.---	25	200	75	210
08.100.3030.---	30	300	85	210
08.100.3035.---	30	350	85	235
08.100.4035.---	40	350	95	255

Surface codes	Material/Surface
---.112	Aluminium, E4/C-0 anodized
---.152	Aluminium, E4/C-34 anodized
---.255	Aluminium, RAL 9016 powder-coated
---.299	Aluminium, special surface
---.316	Brass, polished
---.326	Brass, matt brushed
---.416	Stainless Steel V2A, polished
---.426	Stainless Steel V2A, matt brushed

Accessories:

Fixing types see [page 476](#)

Handle

- stainless steel
- aluminium
- brass

Art.-no.	Ø	L	H	B
08.101.2530.---	25	300	75	112,5
08.101.2535.---	25	350	75	112,5
08.101.3030.---	30	300	85	155
08.101.3035.---	30	350	85	155
08.101.4035.---	40	350	95	170

Surface codes	Material/Surface
---.112	Aluminium, E4/C-0 anodized
---.152	Aluminium, E4/C-34 anodized
---.255	Aluminium, RAL 9016 powder-coated
---.299	Aluminium, special surface
---.316	Brass, polished
---.326	Brass, matt brushed
---.416	Stainless Steel V2A, polished
---.426	Stainless Steel V2A, matt brushed

Special Handle also with special lengths available.

Accessories:

Fixing types see [page 476](#)

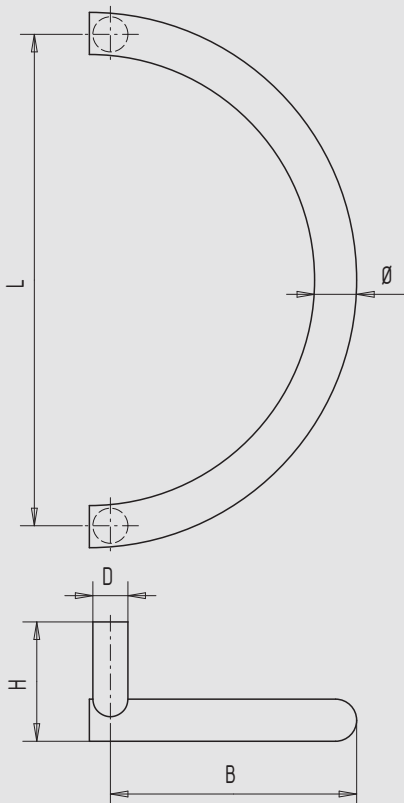
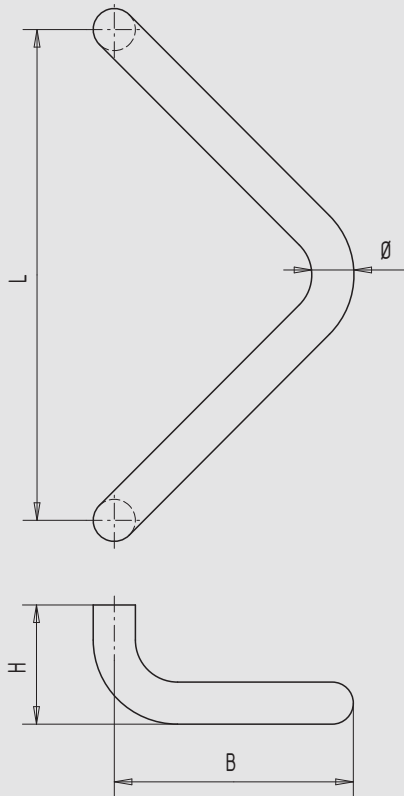

Handle

- stainless steel
- aluminium
- brass

Art.-no.	Ø	L	H	B
08.102.2530.---	25	300	75	145
08.102.2535.---	25	350	75	170
08.102.3030.---	30	300	85	145
08.102.3035.---	30	350	85	170
08.102.4035.---	40	350	95	170

Surface codes	Material/Surface
---.112	Aluminium, E4/C-0 anodized
---.152	Aluminium, E4/C-34 anodized
---.255	Aluminium, RAL 9016 powder-coated
---.299	Aluminium, special surface
---.316	Brass, polished
---.326	Brass, matt brushed
---.416	Stainless Steel V2A, polished
---.426	Stainless Steel V2A, matt brushed

Special Handle also with special lengths available.

Accessories:

Fixing types see [page 476](#)

Stainless steel handle

Art.-no.	Ø	L	H	B	D
08.103.3030.---	30	300	85	190	25
08.103.3035.---	30	350	85	190	25
08.103.4035.---	40	350	95	195	30

Surface codes	Material/Surface
---.416	Stainless Steel V2A, polished
---.426	Stainless Steel V2A, matt brushed

Accessories:

Fixing types see [page 476](#)

1

2

3

4

5

6

7

8

9

i



1

2

3

4

5

6

7

8

9

i

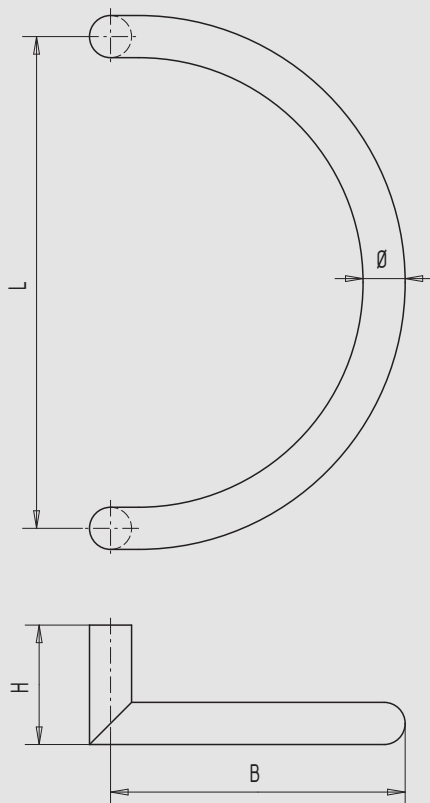
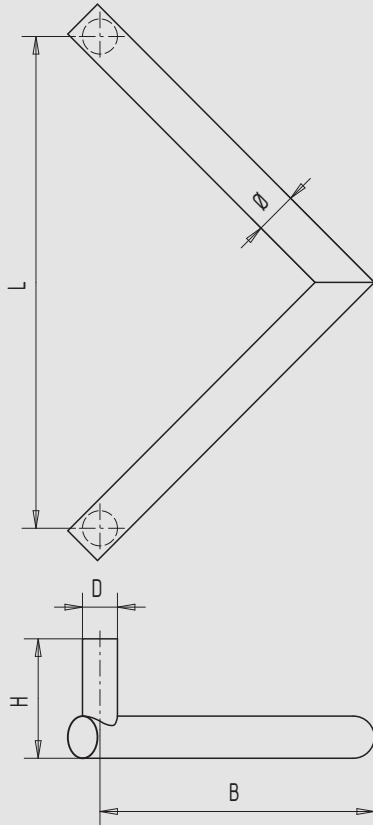

Stainless steel handle

Art.-no.	Ø	L	H	B	D
08.104.2530.---	25	300	75	167	25
08.104.3035.---	30	350	85	195	25
08.104.3535.---	35	350	90	200	25
08.104.4035.---	40	350	95	203	30

Surface codes	Material/Surface
---.416	Stainless Steel V2A, polished
---.426	Stainless Steel V2A, matt brushed
Special	Handle also with special lengths available.

Accessories:
Fixing types see [page 476](#)

Stainless steel handle

Art.-no.	Ø	L	H	B
08.105.3030.---	30	300	85	190
08.105.3035.---	30	350	85	190
08.105.4035.---	40	350	95	195

Surface codes	Material/Surface
---.416	Stainless Steel V2A, polished
---.426	Stainless Steel V2A, matt brushed

Accessories:
Fixing types see [page 476](#)

Stainless steel handle

Art.-no.	Ø	L	H	B
08.106.2530.---	25	300	75	112,50
08.106.3035.---	30	350	85	155
08.106.3535.---	35	350	90	155
08.106.4035.---	40	350	95	170

Surface codes	Material/Surface
---.416	Stainless Steel V2A, polished
---.426	Stainless Steel V2A, matt brushed

Special Handle also with special lengths available.

Accessories:

Fixing types see **page 476**

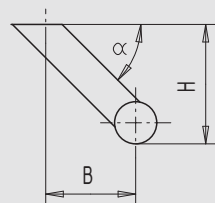
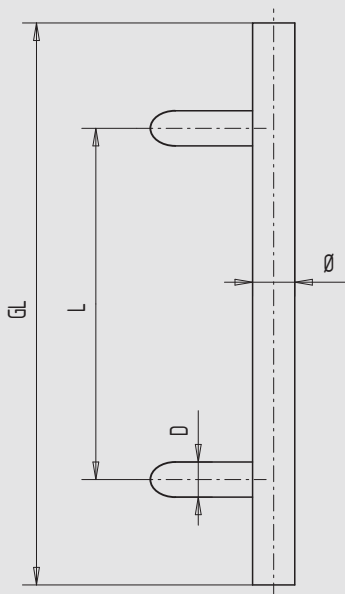
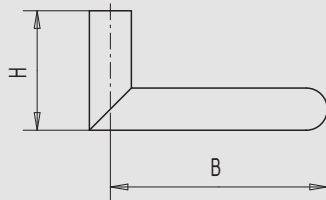
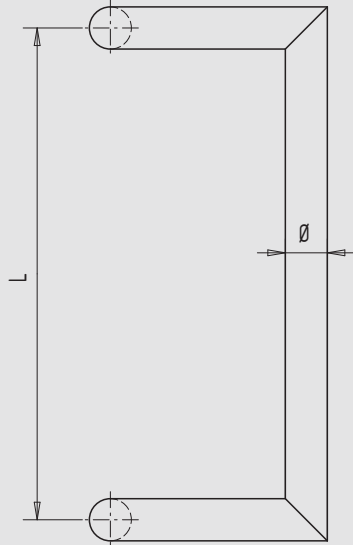

Stainless steel handle

Art.-no.	Ø	Angle-Alpha	GL	L	H	B	D
08.110.2545.---	25	45°	*	*	75	55	25
08.110.2560.---	25	60°	*	*	75	40	25
08.110.3040.---	30	45°	*	*	85	65	25
08.110.3060.---	30	60°	*	*	85	40	25
08.110.3545.---	35	45°	*	*	90	70	25
08.110.3560.---	35	60°	*	*	90	40	25
08.110.4045.---	40	45°	*	*	95	75	30
08.110.4060.---	40	60°	*	*	95	40	30

Surface codes	Material/Surface
---.416	Stainless Steel V2A, polished
---.426	Stainless Steel V2A, matt brushed

Information * acc. to your specifications
Standard dimensions for all handles:
GL = 500 mm, L = 300 mm

Accessories Additional end-pieces for 30 mm diameter, see **page 461**.

Accessories:

Fixing types see **page 476**



1

2

3

4

5

6

7

8

9

i

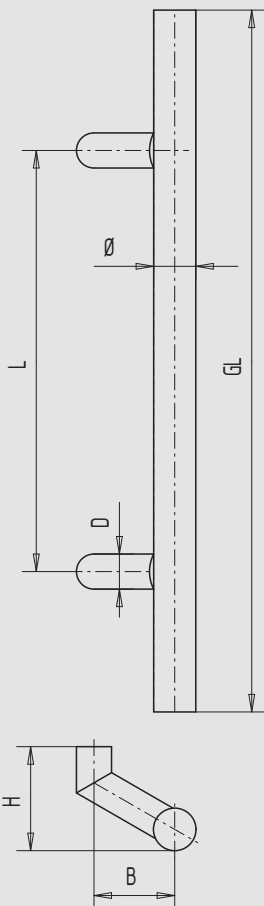
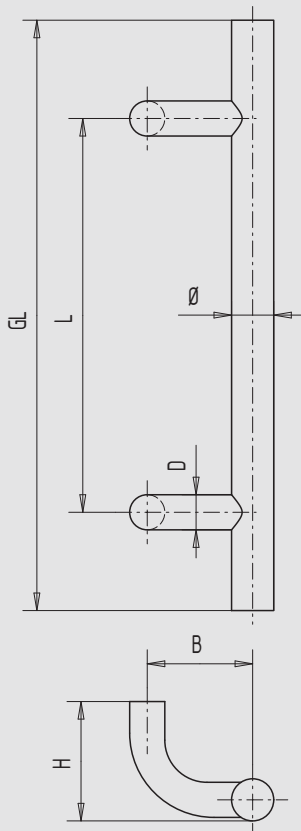

Stainless steel handle

Art.-no.	Ø	GL	L	H	B	D
08.111.2500.---	25	*	*	75	75	25
08.111.3000.---	30	*	*	85	75	25
08.111.3500.---	35	*	*	90	75	25
08.111.4000.---	40	*	*	95	95	30

Surface codes	Material/Surface
---.416	Stainless Steel V2A, polished
---.426	Stainless Steel V2A, matt brushed

Information	* acc. to your specifications Standard dimensions for all handles: GL = 500 mm, L = 300 mm
--------------------	--

Accessories	Additional end-pieces for 30 mm diameter, see page 461 .
--------------------	---

Accessories:
Fixing types see **page 476**

Stainless steel handle

Art.-no.	Ø	GL	L	H	B	D
08.112.2500.---	25	*	*	75	55	25
08.112.3000.---	30	*	*	85	65	25
08.112.3500.---	35	*	*	90	70	25
08.112.4000.---	40	*	*	95	75	30

Surface codes	Material/Surface
---.416	Stainless Steel V2A, polished
---.426	Stainless Steel V2A, matt brushed

Information	* acc. to your specifications Standard dimensions for all handles: GL = 500 mm, L = 300 mm
--------------------	--

Accessories	Additional end-pieces for 30 mm diameter, see page 461 .
--------------------	---

Information	* acc. to your specifications Standard dimensions for all handles: GL = 500 mm, L = 300 mm
--------------------	--

Accessories:
Fixing types see **page 476**

Stainless steel handle

Art.-no.	Ø	L	H	B
08.116.2535.---	25	350	75	75
08.116.3045.---	30	450	85	85
08.116.4045.---	40	450	95	95

Surface codes	Material/Surface
---.416	Stainless Steel V2A, polished
---.426	Stainless Steel V2A, matt brushed

Special Handle also with special lengths available.

Accessories:

Fixing types see **page 476**

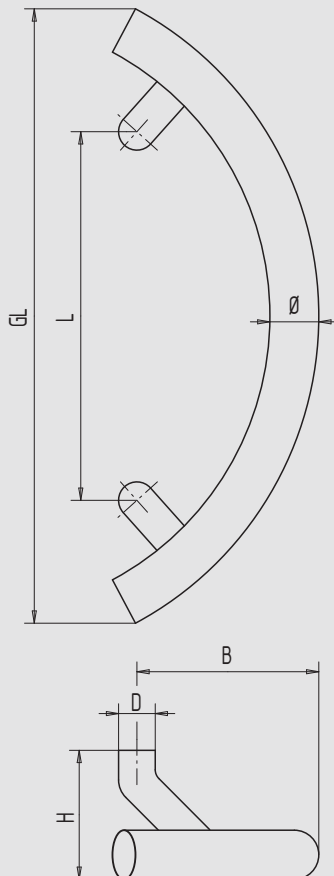
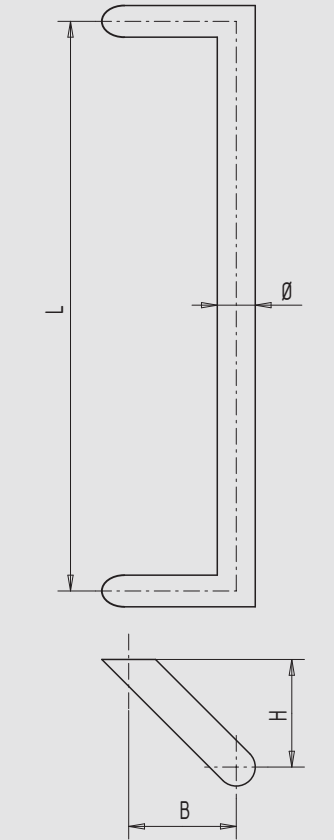

Stainless steel handle

Art.-no.	Ø	GL	L	H	B	D
08.117.2550.---	25	500	300	80	180	20
08.117.3050.---	30	500	300	85	160	25
08.117.4050.---	40	500	300	100	160	30

Surface codes	Material/Surface
---.416	Stainless Steel V2A, polished
---.426	Stainless Steel V2A, matt brushed

Special Handle also with special lengths available.

Accessories:

Fixing types see **page 476**

1

2

3

4

5

6

7

8

9

i



1

2

3

4

5

6

7

8

9

i

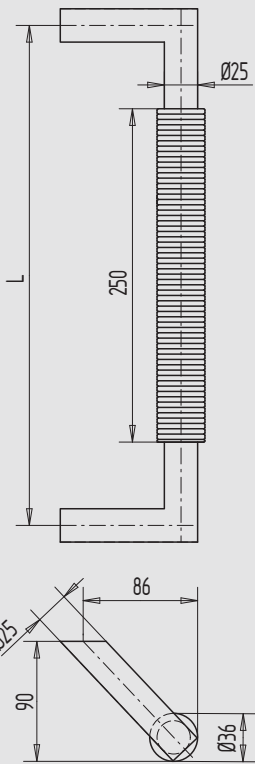
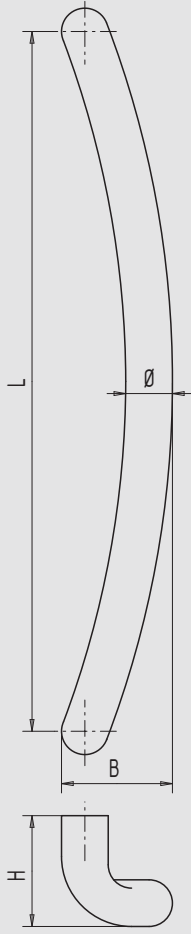

Stainless steel handle

Art.-no.	Ø	L	H	B
08.118.3050.---	30	500	85	95
08.118.4060.---	40	600	95	120

Surface codes	Material/Surface
---.416	Stainless Steel V2A, polished
---.426	Stainless Steel V2A, matt brushed

Special Handle also with special lengths available.

Accessories:

Fixing types see **page 476**

Aluminium handle

■ grab handle C-35 black anodized

Art.-no.	L	Material/Surface
08.119.4037.112	375	Aluminium, E4/C-0 anodized
08.119.6057.112	575	Aluminium, E4/C-0 anodized

Information Grab piece also C-0 silver anodized available.

Accessories:

Fixing types see **page 476**

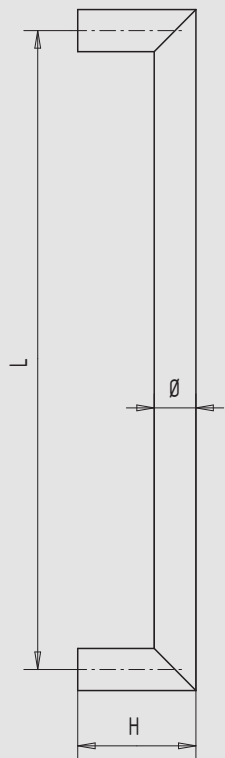
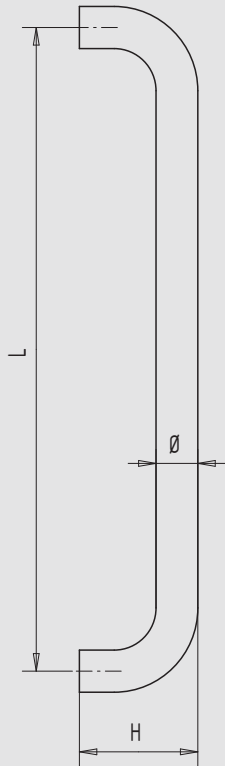

Handle

- stainless steel
- aluminium
- brass

Art.-no.	Ø	L	H
08.125.2000.---	20	* (max. 1400)	70
08.125.2500.---	25	* (max. 1600)	75
08.125.3000.---	30	* (max. 2000)	85
08.125.4000.---	40	* (max. 2300)	95

Surface codes	Material/Surface
---.112	Aluminium, E4/C-0 anodized
---.152	Aluminium, E4/C-34 anodized
---.255	Aluminium, RAL 9016 powder-coated
---.299	Aluminium, special surface
---.316	Brass, polished
---.326	Brass, matt brushed
---.416	Stainless Steel V2A, polished
---.426	Stainless Steel V2A, matt brushed

Information * acc. to your specifications
We recommend a 3rd fixing point when maximum lengths will be exceeded. (Only possible for stainless steel handles.)

Accessories:

Fixing types see [page 476](#)

Stainless steel handle

Art.-no.	Ø	L	H
08.126.2000.---	20	* (max. 1400)	70
08.126.2500.---	25	* (max. 1600)	75
08.126.3000.---	30	* (max. 2000)	85
08.126.3500.---	35	* (max. 2000)	90
08.126.4000.---	40	* (max. 2300)	95

Surface codes	Material/Surface
---.416	Stainless Steel V2A, polished
---.426	Stainless Steel V2A, matt brushed

Information * acc. to your specifications
We recommend a 3rd fixing point when maximum lengths will be exceeded. (Only possible for stainless steel handles.)

Accessories:

Fixing types see [page 476](#)

1

2

3

4

5

6

7

8

9

i



1

2

3

4

5

6

7

8

9

i

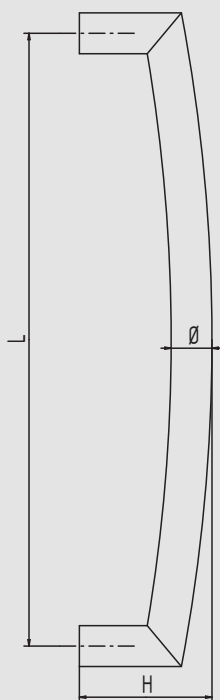
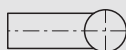
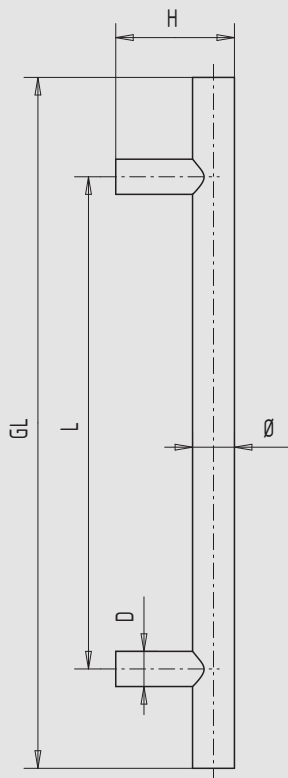

Stainless steel handle

Art.-no.	Ø	GL	L	H	D
08.127.2000.---	20	*	*(max. 1400)	70	20
08.127.2500.---	25	*	*(max. 1600)	75	25
08.127.3000.---	30	*	*(max. 2000)	85	25
08.127.3500.---	35	*	*(max. 2000)	90	25
08.127.4000.---	40	*	*(max. 2300)	95	30

Surface codes	Material/Surface
---.416	Stainless Steel V2A, polished
---.426	Stainless Steel V2A, matt brushed

Information	* acc. to your specifications We recommend a 3rd fixing point when maximum lengths will be exceeded. (Only possible for stainless steel handles.)
-------------	--

Accessories	Additional end-pieces for 30 mm diameter, see page 461 .
-------------	--

Accessories:
Fixing types see [page 476](#)

Stainless steel handle

Art.-no.	Ø	L	H
08.128.3000.---	30	*(max. 2000)	120
08.128.4000.---	40	*(max. 2300)	135

Surface codes	Material/Surface
---.416	Stainless Steel V2A, polished
---.426	Stainless Steel V2A, matt brushed

Information	* acc. to your specifications
-------------	-------------------------------

Accessories:
Fixing types see [page 476](#)

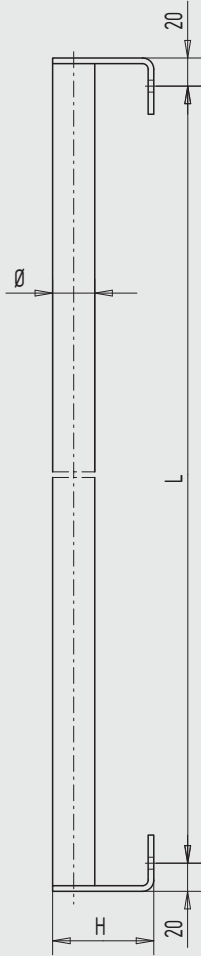

Stainless steel handle

- console connected with stainless steel tube
- threaded bush welded
- up to 2600 mm

Art.-no.	Ø	Material thickness	L	H
08.132.2502.---	25	2	* (max. 1600)	65
08.132.3002.---	30	2	* (max. 2000)	70
08.132.3502.---	35	2	* (max. 2000)	75
08.132.4002.---	40	2	* (max. 2200)	80
08.132.4004.---	40	4	* (max. 2600)	80

Surface codes	Material/Surface
---.416	Stainless Steel V2A, polished
---.426	Stainless Steel V2A, matt brushed

Information * acc. to your specifications

Accessories:

Fixing material [page 494](#)

1

2

3

4

5

6

7

8

9

i



1

2

3

4

5

6

7

8

9

i

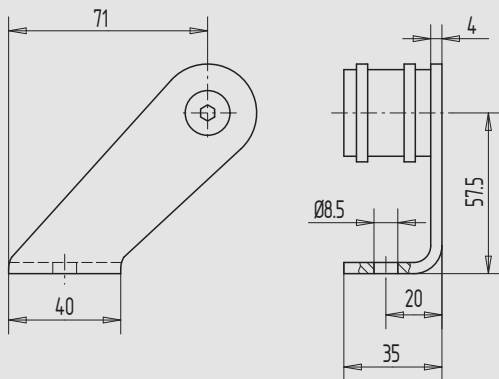
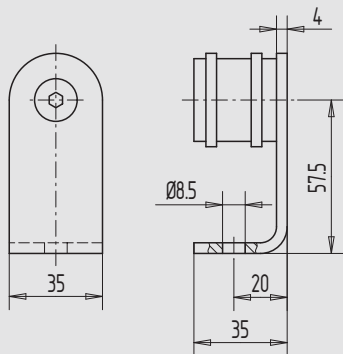
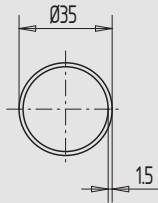
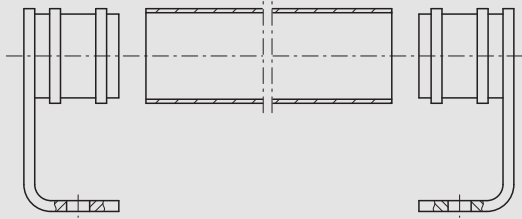

Illustration shows left handed version

System-handle

- 35 mm tube diameter
- for self-customization
- usable up to 1500 mm tube length (from 1500 mm with re-inforcement tube)
- consisting of the following parts:

Stainless steel tube

- 35 x 1,5 mm diameter

Art.-no.	L	Material/Surface
08.133.3000.426	3000	Stainless Steel V2A, matt brushed
08.133.0000.426	*	Stainless Steel V2A, matt brushed
Information	* acc. to your specifications	

Stainless steel holder no. 6715

- angled to the inside

Art.-no.	Material/Surface
08.134.1000.426	Stainless Steel V2A, matt brushed

Stainless steel holder no. 6716

- appr. 45° cropped, angled to the inside

Art.-no.	Direction	Material/Surface
08.135.1010.426	right	Stainless Steel V2A, matt brushed
08.135.1020.426	left	Stainless Steel V2A, matt brushed

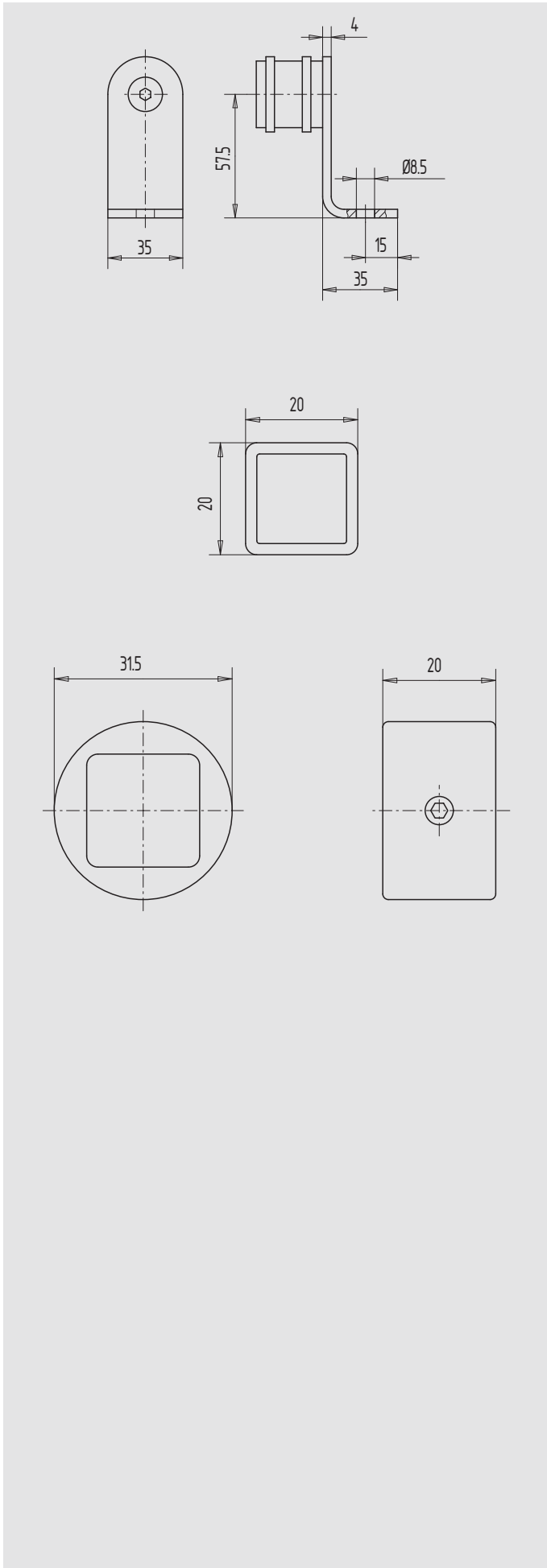

Stainless steel holder no. 6717

- angled to the outside

Art.-no.	Material/Surface
08.136.0000.426	Stainless Steel V2A, matt brushed

Steel reinforcement tube

- for tube lengths from 1500 mm (up to max. 2100 mm)
- dimension 20 x 20 x 2 mm
- Fixed length = 3000 mm

Art.-no.	Material/Surface
08.138.0000.010	Steel, zinc-plated

PVC distance bush no. 6719

- for steel reinforcement tube
- with fixing screw

Art.-no.	Material/Surface
08.139.0000.505	PVC, nature

1

2

3

4

5

6

7

8

9

i



1

2

3

4

5

6

7

8

9

i

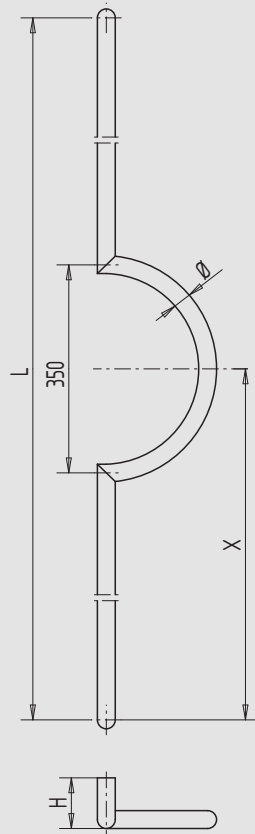

Illustration shows right handed version

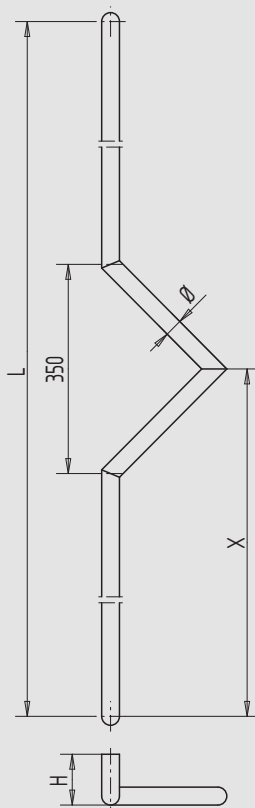

Illustration shows right handed version

Stainless steel handle

Art.-no.	Ø	L	H
08.144.3000.---	30	* (max. 1800)	85
08.144.4000.---	40	* (max. 2000)	95

Surface codes	Material/Surface
---.416	Stainless Steel V2A, polished
---.426	Stainless Steel V2A, matt brushed

Attention Please specify measurement X and handle direction!

Information * acc. to your specifications
We recommend a 3rd fixing point when maximum lengths will be exceeded. (Only possible for stainless steel handles.)

Accessories: Fixing types see [page 476](#)

Stainless steel handle

Art.-no.	Ø	L	H
08.145.3000.---	30	* (max. 1800)	85
08.145.4000.---	40	* (max. 2000)	95

Surface codes	Material/Surface
---.416	Stainless Steel V2A, polished
---.426	Stainless Steel V2A, matt brushed

Attention Please specify measurement X and handle direction!

Information * acc. to your specifications
We recommend a 3rd fixing point when maximum lengths will be exceeded. (Only possible for stainless steel handles.)

Accessories: Fixing types see [page 476](#)

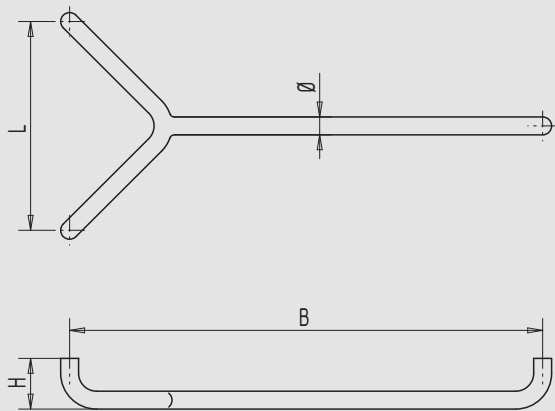
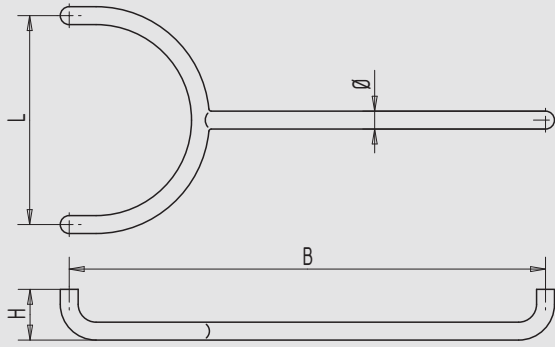

Stainless steel handle

Art.-no.	Ø	L	H	B
08.150.3000.---	30	350	85	*
08.150.4000.---	40	350	95	*

Surface codes	Material/Surface
---.416	Stainless Steel V2A, polished
---.426	Stainless Steel V2A, matt brushed

Information * acc. to your specifications

Accessories:

Fixing types see **page 476**

Stainless steel handle

Art.-no.	Ø	L	H	B
08.151.3000.---	30	350	85	*
08.151.4000.---	40	350	95	*

Surface codes	Material/Surface
---.416	Stainless Steel V2A, polished
---.426	Stainless Steel V2A, matt brushed

Information * acc. to your specifications

Accessories:

Fixing types see **page 476**

1
2
3
4
5
6
7
8
9
i

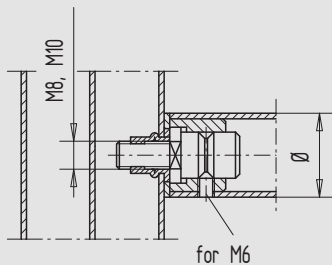
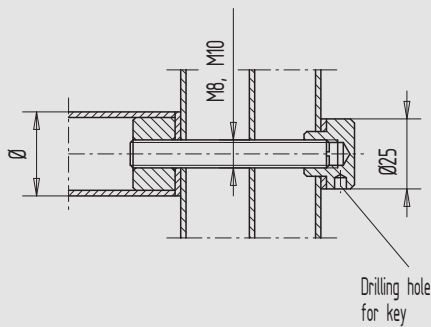
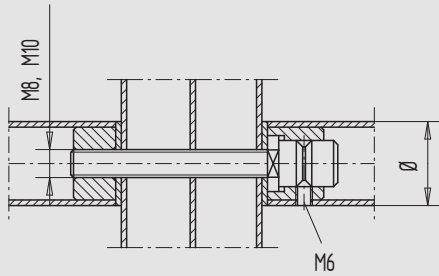

Fixing type "K"

■ pairwise for tubular frame doors

Art.-no.	Ø	Thread
08.154.2000.000	20	M8
08.154.2500.000	25	M8
08.154.3000.000	30	M10
08.154.3500.000	35	M10
08.154.4000.000	40	M10

Attention 1 pair of handles = 2 fixing units

Information Please specify the door thickness!

Fixing type "L"

■ single-side fixing for tubular frame doors with counter roses

Art.-no.	Ø	Thread
08.155.2000.---	20	M8
08.155.2500.---	25	M8
08.155.3000.---	30	M10
08.155.3500.---	35	M10
08.155.4000.---	40	M10

Surface codes	Material/Surface
---.112	Aluminium, E4/C-0 anodized
---.152	Aluminium, E4/C-34 anodized
---.255	Aluminium, RAL 9016 powder-coated
---.299	Aluminium, special surface
---.316	Brass, polished
---.326	Brass, matt brushed
---.416	Stainless Steel V2A, polished
---.426	Stainless Steel V2A, matt brushed

Attention 1 piece of handle = 2 fixing units

Information Please specify the door thickness!

Fixing type "O"

■ single-side fixing for tubular frame doors
■ for installation with blind riveting nuts

Art.-no.	Ø	Thread
08.156.2000.000	20	M8
08.156.2500.000	25	M8
08.156.3000.000	30	M10
08.156.3500.000	35	M10
08.156.4000.000	40	M10

Attention 1 piece of handle = 2 fixing units

1
2
3
4
5
6
7
8
9
i

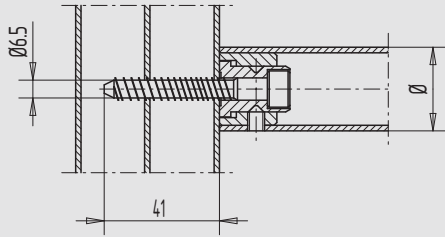

Fixing type "E"

- single-side fixing for tubular frame doors
- self-cutting
- drilling hole in the profile 6,5 mm diameter

Art.-no.	Ø
08.158.2000.000	20
08.158.2500.000	25
08.158.3000.000	30
08.158.3500.000	35
08.158.4000.000	40

Attention 1 piece of handle = 2 fixing units

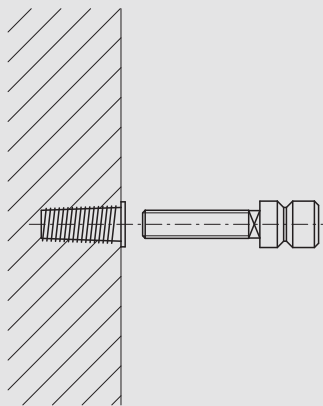

Fixing type "H"

- single-side fixing for wooden doors
- with rampa muffle

Art.-no.	Ø	Thread
08.159.2000.---	20	M8
08.159.2500.---	25	M8
08.159.3000.---	30	M10
08.159.3500.---	35	M10
08.159.4000.---	40	M10

Attention 1 piece of handle = 2 fixing units

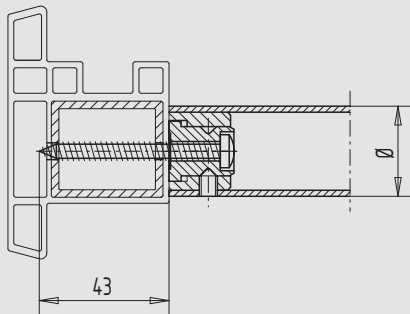

Fixing type "S"

- single-side fixing for PVC doors
- self-cutting
- drilling hole in the profile 5,6 mm diameter, H11

Art.-no.	Ø
08.161.2000.000	20
08.161.2500.000	25
08.161.3000.000	30
08.161.3500.000	35
08.161.4000.000	40

Attention 1 piece of handle = 2 fixing units

1

2

3

4

5

6

7

8

9

i

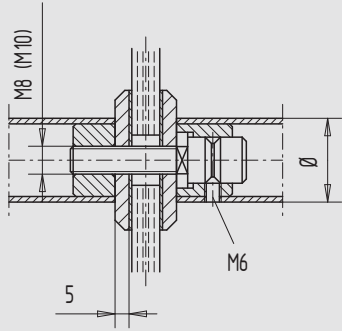

Fixing type "M"

- pairwise for glass doors
- glass drilling hole 18 mm diameter
- with shims

Art.-no.	Ø	Thread
08.166.2000.---	20	M8
08.166.2500.---	25	M8
08.166.3000.---	30	M10
08.166.3500.---	35	M10
08.166.4000.---	40	M10

Surface codes	Material/Surface
---.112	Aluminium, E4/C-0 anodized
---.152	Aluminium, E4/C-34 anodized
---.250	Aluminium, RAL 9010 powder-coated
---.255	Aluminium, RAL 9016 powder-coated
---.299	Aluminium, special surface
---.316	Brass, polished
---.326	Brass, matt brushed
---.416	Stainless Steel V2A, polished
---.426	Stainless Steel V2A, matt brushed

Attention 1 pair of handles = 2 fixing units

Information Please specify the door thickness!

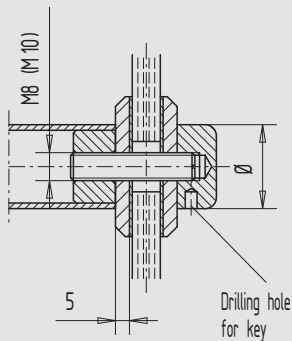

Fixing type "N"

- single-side fixing for glass doors
- with counter roses
- glass drilling hole 18 mm diameter
- with shims

Art.-no.	Ø	Thread
08.167.2000.---	20	M8
08.167.2500.---	25	M8
08.167.3000.---	30	M10
08.167.3500.---	35	M10
08.167.4000.---	40	M10

Surface codes	Material/Surface
---.112	Aluminium, E4/C-0 anodized
---.152	Aluminium, E4/C-34 anodized
---.250	Aluminium, RAL 9010 powder-coated
---.255	Aluminium, RAL 9016 powder-coated
---.299	Aluminium, special surface
---.316	Brass, polished
---.326	Brass, matt brushed
---.416	Stainless Steel V2A, polished
---.426	Stainless Steel V2A, matt brushed

Attention 1 piece of handle = 2 fixing units

Information Please specify the door thickness!

1
2
3
4
5
6
7
8
9
i

Crystal glass handle

Art.-no.	GL	L	Material/Surface Console
08.170.3221.374	320	210	Brass, polished chrome-plated
08.170.3221.426	320	210	Stainless Steel V2A, matt brushed
08.170.5026.374	500	260	Brass, polished chrome-plated
08.170.5026.426	500	260	Stainless Steel V2A, matt brushed

Accessories:

Fixing types [page 480](#)

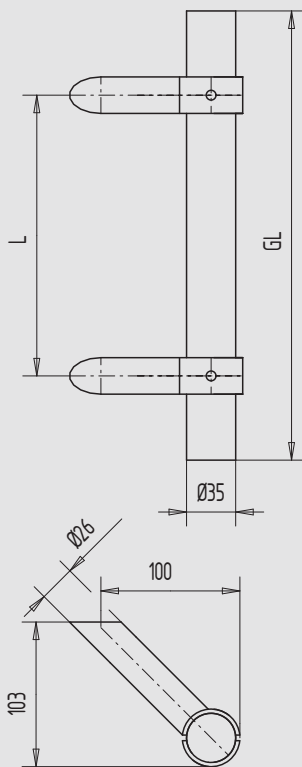
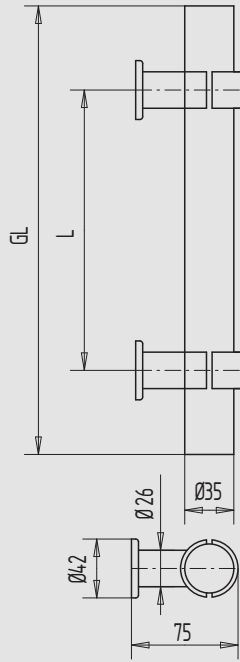

Illustration shows right handed version

Crystal glass handle

■ with matt grinded stainless steel consoles

Art.-no.	GL	L	Direction
08.172.3210.426	320	210	right showing
08.172.3220.426	320	210	left showing
08.172.5010.426	500	260	right showing
08.172.5020.426	500	260	left showing

Accessories:

Fixing types [page 480](#)

1

2

3

4

5

6

7

8

9

i



1

2

3

4

5

6

7

8

9

i

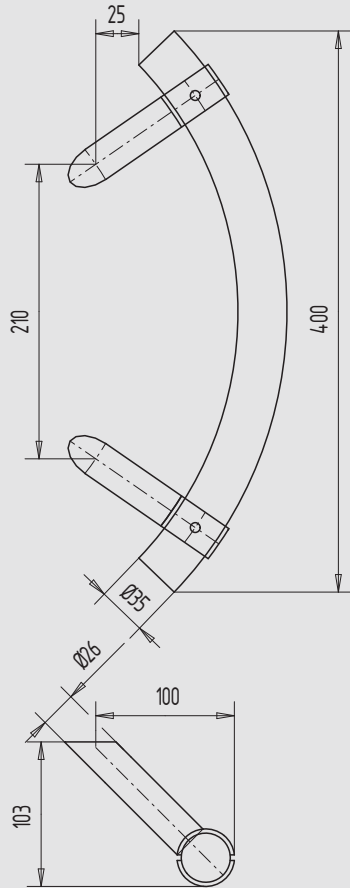
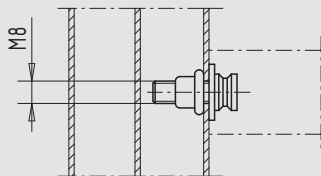
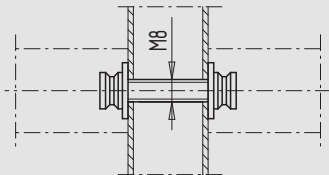

Illustration shows right handed version



Crystal glass handle

- with matt grinded stainless steel consoles

Art.-no.	Direction
08.176.0010.426	right showing
08.176.0020.426	left showing

Accessories:

Fixing types, see below

Fixing unit

- pairwise for tubular frame- and glass doors

Art.-no. 08.179.0000.000

Attention 1 pair of handles = 2 fixing unit

Information Please specify the door thickness!

Fixing unit

- single-side fixing for tubular frame doors
- for installation with blind riveting nuts

Art.-no. 08.180.0000.000

Attention 1 piece of handle = 2 fixing unit

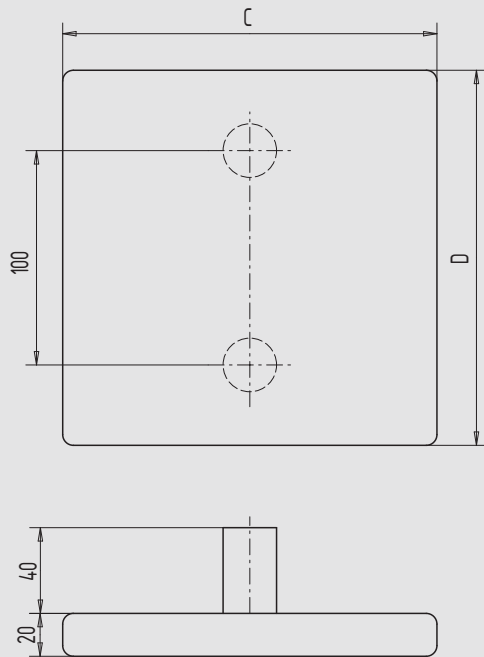
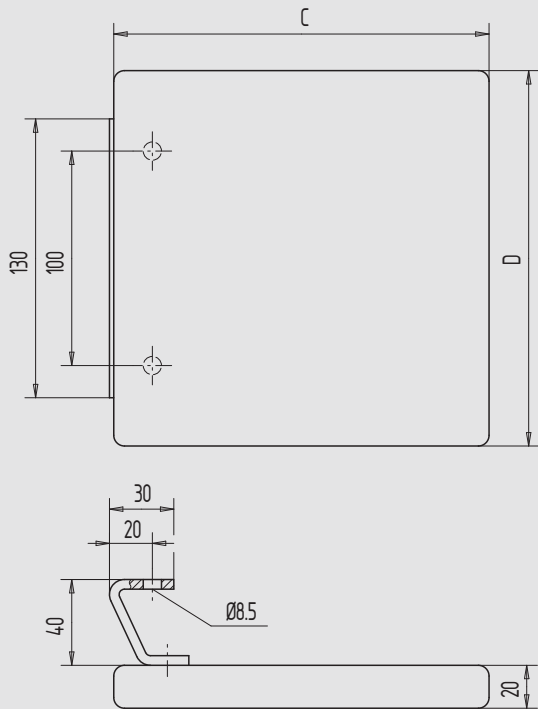

Stainless steel handle

- with diagonal consoles for tubular frame doors

Art.-no.	C	D	Material/Surface
08.200.0015.416	150	150	Stainless Steel V2A, polished
08.200.0015.426	150	150	Stainless Steel V2A, matt brushed
08.200.0017.416	175	175	Stainless Steel V2A, polished
08.200.0017.426	175	175	Stainless Steel V2A, matt brushed
08.200.0020.416	200	200	Stainless Steel V2A, polished
08.200.0020.426	200	200	Stainless Steel V2A, matt brushed

Accessories:

Fixing material [page 494](#)

Stainless steel handle

- with tubular consoles for glass doors

Art.-no.	C	D	Material/Surface
08.200.2015.416	150	150	Stainless Steel V2A, polished
08.200.2015.426	150	150	Stainless Steel V2A, matt brushed
08.200.2017.416	175	175	Stainless Steel V2A, polished
08.200.2017.426	175	175	Stainless Steel V2A, matt brushed
08.200.2020.416	200	200	Stainless Steel V2A, polished
08.200.2020.426	200	200	Stainless Steel V2A, matt brushed

Accessories:

Fixing types [page 476](#)

1

2

3

4

5

6

7

8

9

i

1

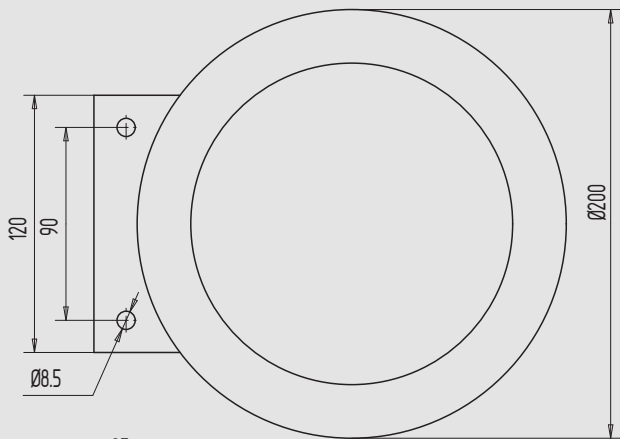

2

3

4

5

6

7

8

9

i

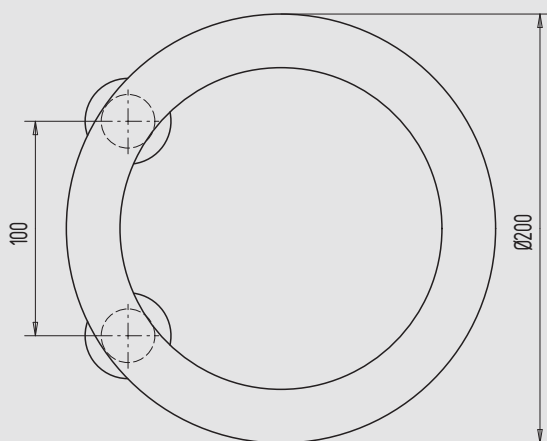

Stainless steel handle

- with diagonal consoles for tubular frame doors

Art.-no.	Material/Surface
08.202.0020.416	Stainless Steel V2A, polished
08.202.0020.426	Stainless Steel V2A, matt brushed

Accessories:

Fixing material [page 494](#)

Stainless steel handle

- with tubular consoles for glass doors

Art.-no.	Material/Surface
08.203.2020.416	Stainless Steel V2A, polished
08.203.2020.426	Stainless Steel V2A, matt brushed

Accessories:

Fixing types see [page 476](#)

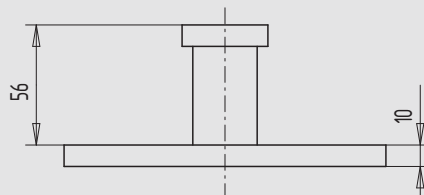
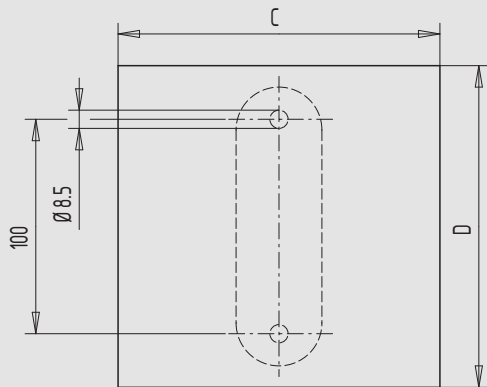
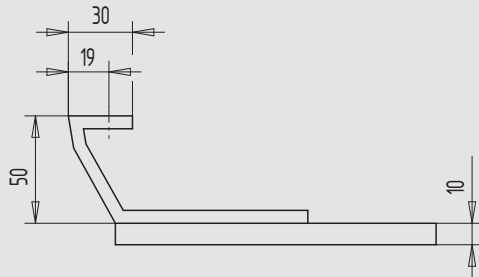
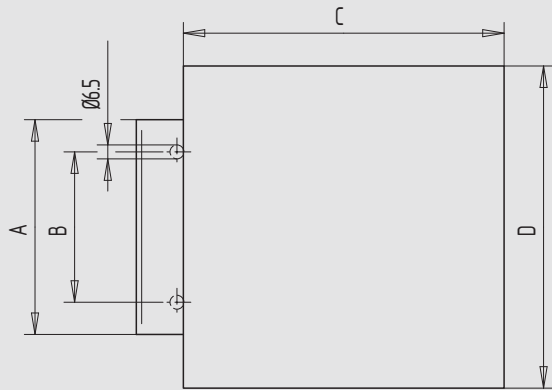

Aluminium handle

■ with diagonal consoles for tubular frame doors

Art.-no.	A	B	C	D
08.210.0015.---	100	70	150	150
08.210.0017.---	120	100	175	175
08.210.0020.---	150	120	200	200

Surface codes	Material/Surface
---.112	Aluminium, E4/C-0 anodized
---.152	Aluminium, E4/C-34 anodized
---.255	Aluminium, RAL 9016 powder-coated
---.299	Aluminium, special surface

Accessories:

Fixing material [page 494](#)

Aluminium handle

■ with block console for glass doors

Art.-no.	C	D
08.210.1015.---	150	150
08.210.1017.---	175	175
08.210.1020.---	200	200

Surface codes	Material/Surface
---.112	Aluminium, E4/C-0 anodized
---.152	Aluminium, E4/C-34 anodized
---.255	Aluminium, RAL 9016 powder-coated
---.299	Aluminium, special surface

Accessories:

Fixing material [page 494](#)

1

2

3

4

5

6

7

8

9

i

1

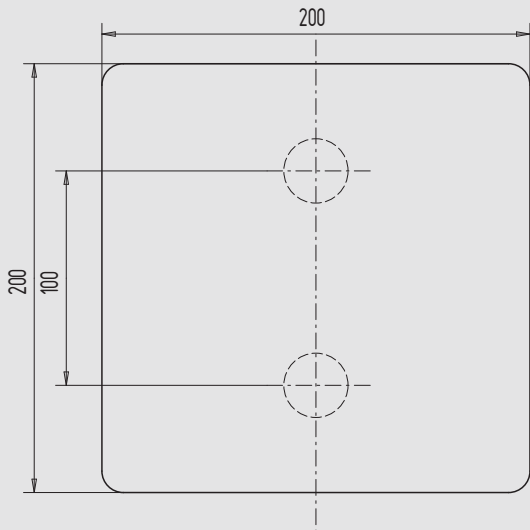

2

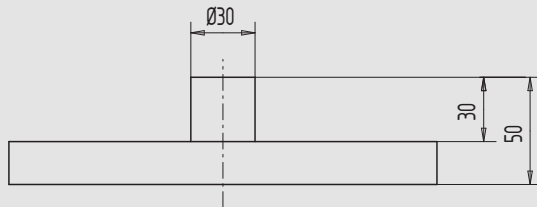

3

4

5

6

7

8

9

i

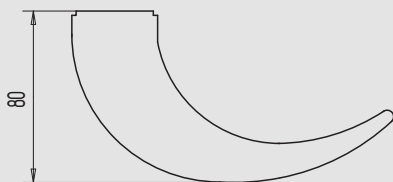
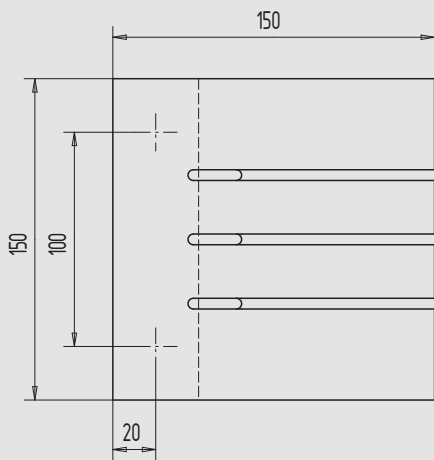

Aluminium handle

■ with tubular consoles for glass doors

Art.-no.	Material/Surface
08.212.2020.112	Aluminium, E4/C-0 anodized
08.212.2020.152	Aluminium, E4/C-34 anodized
08.212.2020.255	Aluminium, RAL 9016 powder-coated
08.212.2020.299	Aluminium, special surface

Accessories:

Fixing types see [page 476](#)

Aluminium handle

Art.-no.	Material/Surface
08.213.0000.112	Aluminium, E4/C-0 anodized

Accessories:

Fixing types [page 480](#)

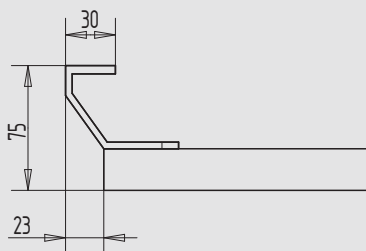
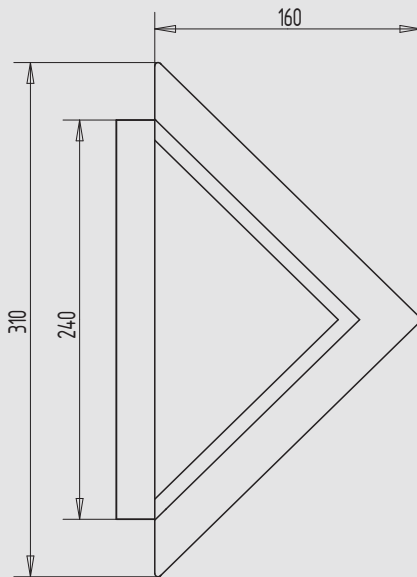
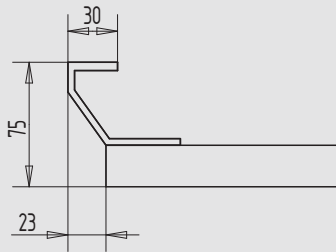
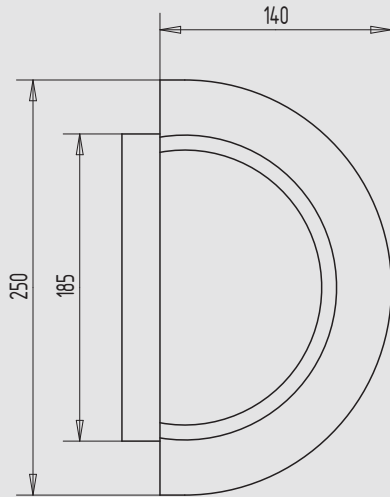

Glass handle

- console RAL 9016 white powder coated
- with chrome plated screen

Art.-no.	Glass color
08.220.0010.255	Opal glass
08.220.0020.255	Crystalglass
08.220.0030.255	blue glass

Accessories:

Fixing material [page 494](#)

Glass handle

- console RAL 9016 white powder coated
- with chrome plated screen

Art.-no.	Glass color
08.221.0010.255	Opal glass
08.221.0020.255	Crystalglass
08.221.0030.255	blue glass

Accessories:

Fixing material [page 494](#)

1

2

3

4

5

6

7

8

9

i

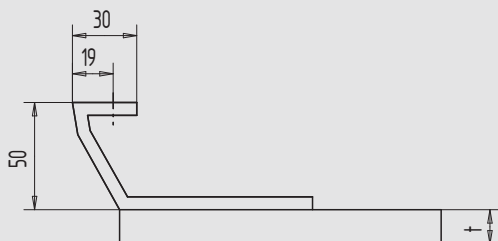
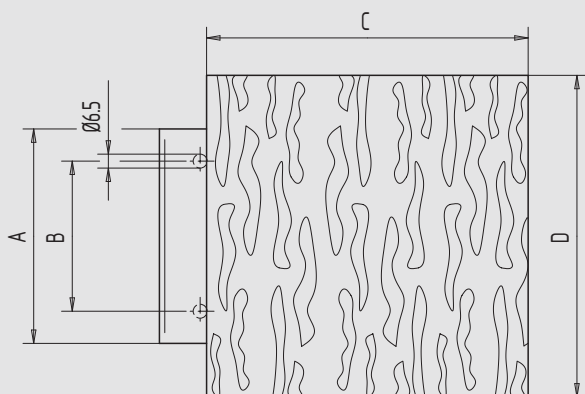
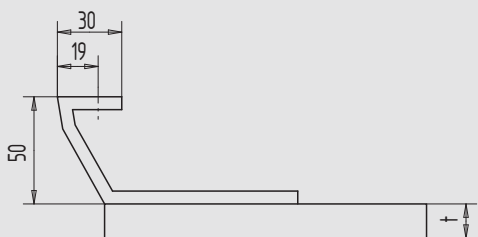
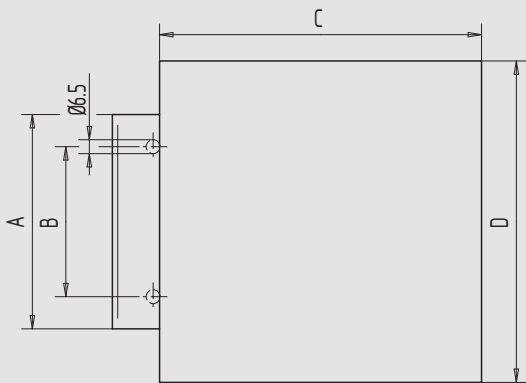

PVC handle

- black, plane pressed
- with diagonal aluminium console
- for tubular frame doors

Art.-no.	A	B	C	D	t
08.240.0015.---	100	70	150	150	16
08.240.0017.---	120	100	175	175	20
08.240.0020.---	150	120	200	200	20

Surface codes	Material/Surface
---.112	Aluminium, E4/C-0 anodized
---.152	Aluminium, E4/C-34 anodized
---.255	Aluminium, RAL 9016 powder-coated
---.299	Aluminium, special surface

Attention	Not lightfast: art.-no. 08.240.0015.../art.-no. 08.240.0017... Lightfast: art.-no. 08.240.0020...

Information	All PVC plates also lightfast and different colored available.

Accessories:

Fixing material [page 494](#)

PVC handle

- black, rough grained
- not lightfast
- with diagonal aluminium console
- for tubular frame doors

Art.-no.	A	B	C	D	t
08.241.0015.---	100	70	150	150	16
08.241.0017.---	120	100	175	175	18,5
08.241.0020.---	150	120	200	200	18,5

Surface codes	Material/Surface
---.112	Aluminium, E4/C-0 anodized
---.152	Aluminium, E4/C-34 anodized
---.255	Aluminium, RAL 9016 powder-coated
---.299	Aluminium, special surface

Accessories:

Fixing material [page 494](#)

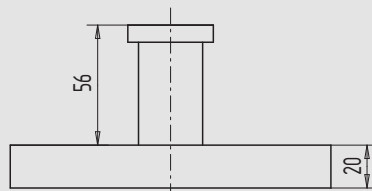
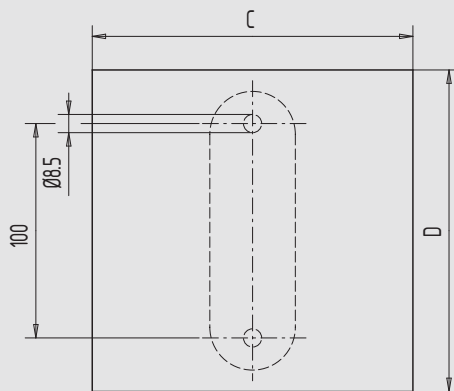
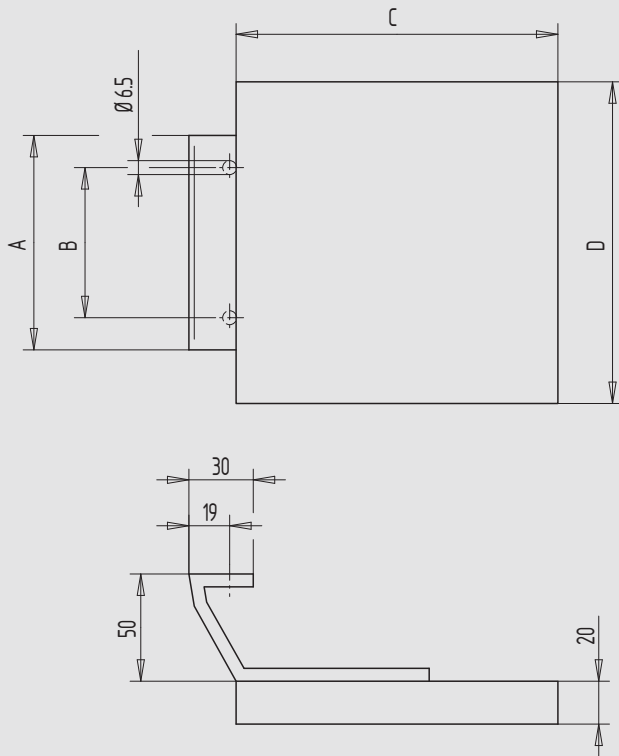

Wooden handle

- wood/cambala (similar to teak)
- with diagonal aluminium console
- for tubular frame doors

Art.-no.	A	B	C	D
08.260.0015.---	100	70	150	150
08.260.0017.---	120	100	175	175
08.260.0020.---	150	120	200	200

Surface codes	Material/Surface
---.112	Aluminium, E4/C-0 anodized
---.152	Aluminium, E4/C-34 anodized
---.255	Aluminium, RAL 9016 powder-coated
---.299	Aluminium, special surface

Information Handle also with further wood sorts available (e. g. oak, beech, maple).

Accessories:

Fixing material [page 494](#)

Wooden handle

- wood/cambala (similar to teak)
- with aluminium block console for glass doors

Art.-no.	C	D
08.260.1015.---	150	150
08.260.1017.---	175	175
08.260.1020.---	200	200

Surface codes	Material/Surface
---.112	Aluminium, E4/C-0 anodized
---.152	Aluminium, E4/C-34 anodized
---.255	Aluminium, RAL 9016 powder-coated
---.299	Aluminium, special surface

Information Handle also with further wood sorts available (e. g. oak, beech, maple).

Accessories:

Fixing material [page 494](#)

1

2

3

4

5

6

7

8

9

i

1

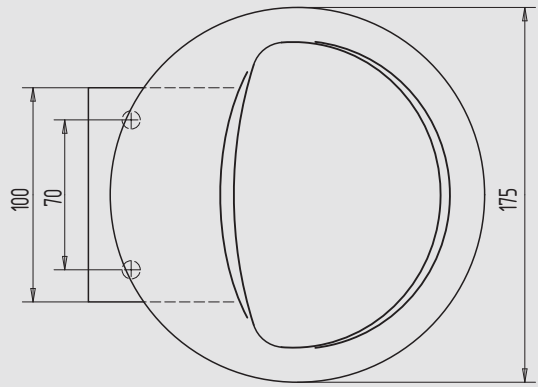

2

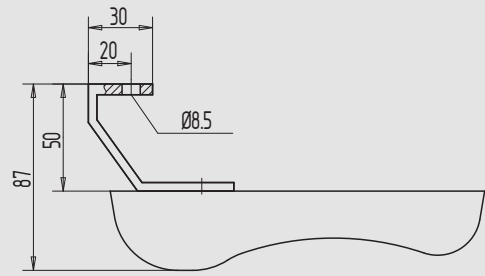

3

4

5

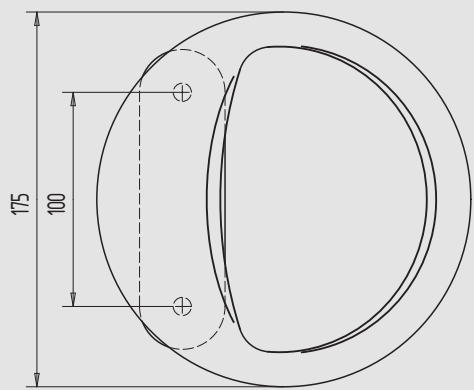

6

7

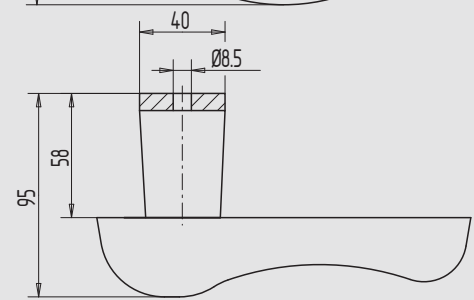

8

9

i

Bronze handle

- with diagonal consoles for tubular frame doors

Art.-no.

08.280.0000.905

Accessories:

Fixing material [page 494](#)

Bronze handle

- with block console for glass doors

Art.-no.

08.280.1000.905

Accessories:

Fixing material [page 494](#)

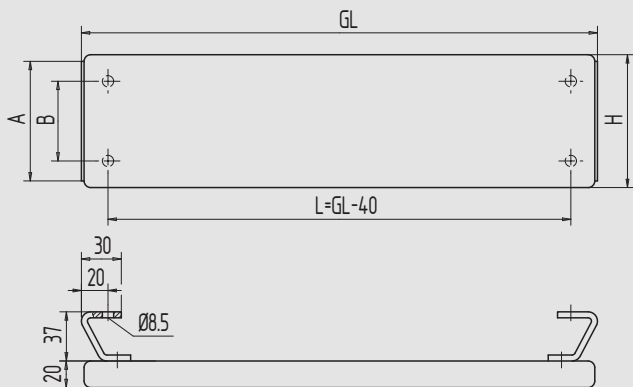

Stainless steel handle

■ with diagonal consoles for tubular frame doors

Art.-no.	H	GL	A	B
08.300.0010.---	100	*	80	60
08.300.0015.---	150	*	130	100
08.300.0020.---	200	*	130	100

Surface codes	Material/Surface
---.416	Stainless Steel V2A, polished
---.426	Stainless Steel V2A, matt brushed

Information * acc. to your specifications
Handle also with tubular consoles for glass doors available.

Accessories:

Fixing material [page 494](#)

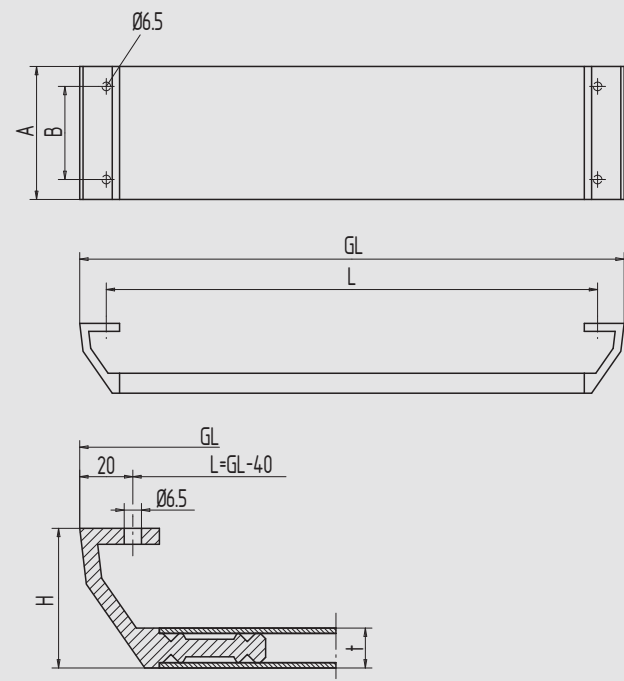

Aluminium handle

■ with diagonal consoles for tubular frame doors

Art.-no.	A	B	GL	H	t
08.330.0010.---	100	70	*	52,5	15
08.330.0012.---	120	100	*	52,5	15
08.330.0015.---	150	120	*	55	20
08.330.0018.---	180	150	*	55	20
08.330.0020.---	200	175	*	55	20

Surface codes	Material/Surface
---.112	Aluminium, E4/C-0 anodized
---.152	Aluminium, E4/C-34 anodized
---.255	Aluminium, RAL 9016 powder-coated
---.299	Aluminium, special surface

Information * acc. to your specifications

Accessories:

Fixing material [page 494](#)

1

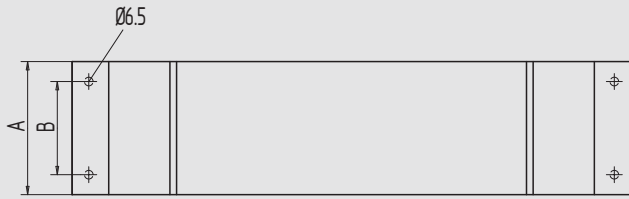

2

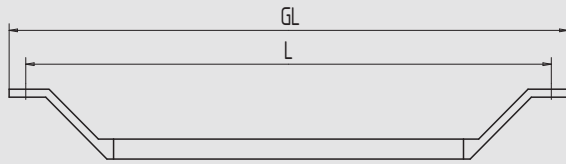

3

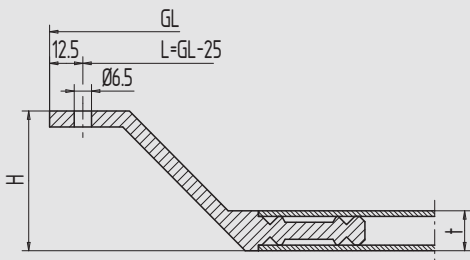

4

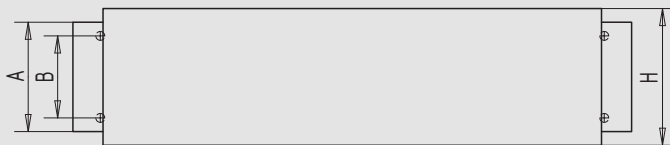

5

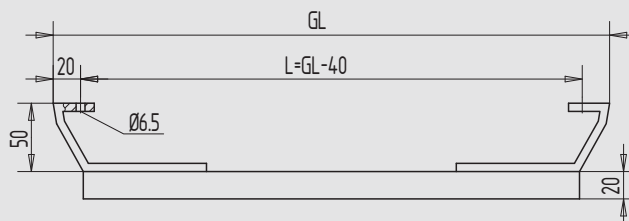

6

7

8

9

i

Aluminium handle

■ with angled consoles for tubular frame doors

Art.-no.	A	B	GL	H	t
08.331.0010.---	100	70	*	52,5	15
08.331.0012.---	120	100	*	52,5	15
08.331.0015.---	150	120	*	55	20
08.331.0018.---	180	150	*	55	20
08.331.0020.---	200	175	*	55	20

Surface codes	Material/Surface
---.112	Aluminium, E4/C-0 anodized
---.152	Aluminium, E4/C-34 anodized
---.255	Aluminium, RAL 9016 powder-coated
---.299	Aluminium, special surface

Information * acc. to your specifications

Accessories:

Fixing material [page 494](#)

Wooden handle

■ wood/cambala (similar to teak)
 ■ with diagonal aluminium consoles
 ■ for tubular frame doors

Art.-no.	H	GL	A	B
08.370.0010.---	100	*	80	60
08.370.0012.---	120	*	100	70
08.370.0015.---	150	*	120	100
08.370.0017.---	175	*	150	120
08.370.0020.---	200	*	175	150
08.370.0025.---	250	*	200	175

Surface codes	Material/Surface
---.112	Aluminium, E4/C-0 anodized
---.152	Aluminium, E4/C-34 anodized
---.255	Aluminium, RAL 9016 powder-coated
---.299	Aluminium, special surface

Information *acc. to your specifications (e. g. oak, beech, maple)

Accessories:

Fixing material [page 494](#)

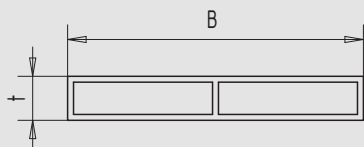

Aluminium hollow-profile

■ customized or standard length

Art.-no.	B	t	L
08.400.0010.---	100	15	*
08.400.0012.---	120	15	*
08.400.0015.---	150	20	*
08.400.0018.---	180	20	*
08.400.0020.---	200	20	*

Surface codes	Material/Surface
---.105	Aluminium, bright
---.112	Aluminium, E4/C-0 anodized
---.114	Aluminium, E6/C-0 anodized
---.152	Aluminium, E4/C-34 anodized
---.255	Aluminium, RAL 9016 powder-coated

Information * acc. to your specifications
Length = 5000 mm

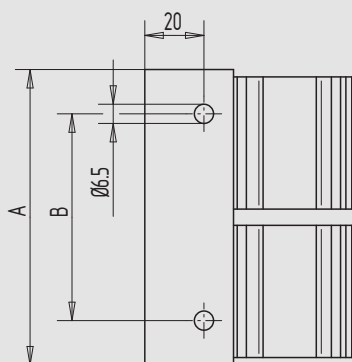

Aluminium console

■ diagonal

Art.-no.	A	B
08.500.0010.---	100	70
08.500.0012.---	120	100

Surface codes	Material/Surface
---.105	Aluminium, bright
---.112	Aluminium, E4/C-0 anodized
---.114	Aluminium, E6/C-0 anodized
---.152	Aluminium, E4/C-34 anodized
---.255	Aluminium, RAL 9016 powder-coated

Information Consoles will always be delivered with 2 stainless steel flat springs.

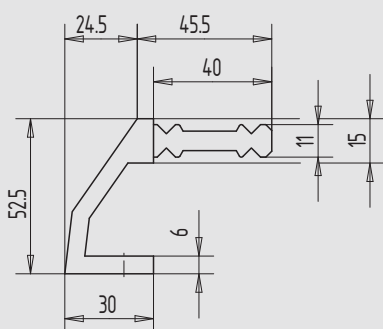



1

2

3

4

5

6

7

8

9

i

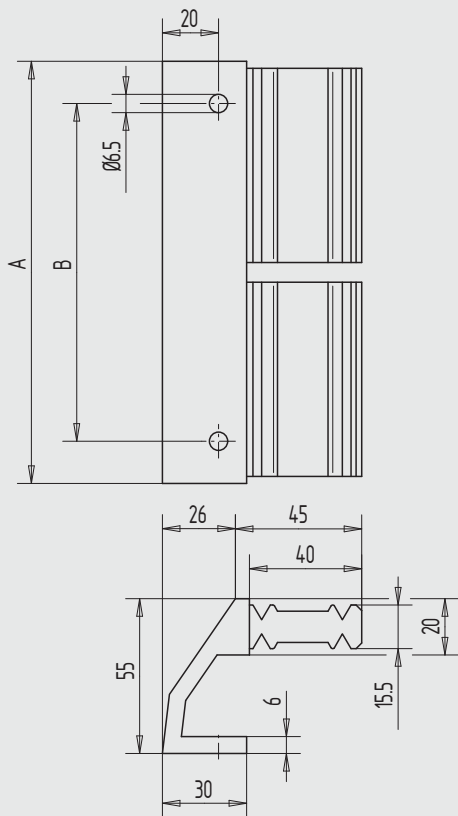

Aluminium console

■ diagonal

Art.-no.	A	B
08.501.0015.---	150	120
08.501.0018.---	180	150
08.501.0020.---	200	175

Surface codes	Material/Surface
---.105	Aluminium, bright
---.112	Aluminium, E4/C-0 anodized
---.114	Aluminium, E6/C-0 anodized
---.152	Aluminium, E4/C-34 anodized
---.255	Aluminium, RAL 9016 powder-coated

Information Consoles will always be delivered with 2 stainless steel flat springs.

Aluminium console

■ angled

Art.-no.	A	B
08.502.0010.---	100	70
08.502.0012.---	120	100

Surface codes	Material/Surface
---.105	Aluminium, bright
---.112	Aluminium, E4/C-0 anodized
---.114	Aluminium, E6/C-0 anodized
---.152	Aluminium, E4/C-34 anodized
---.255	Aluminium, RAL 9016 powder-coated

Information Consoles will always be delivered with 2 stainless steel flat springs.

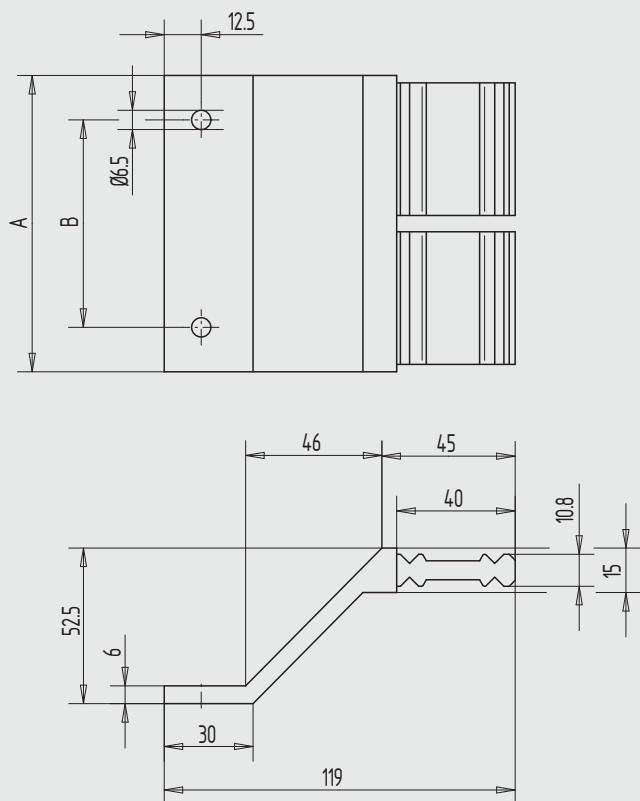

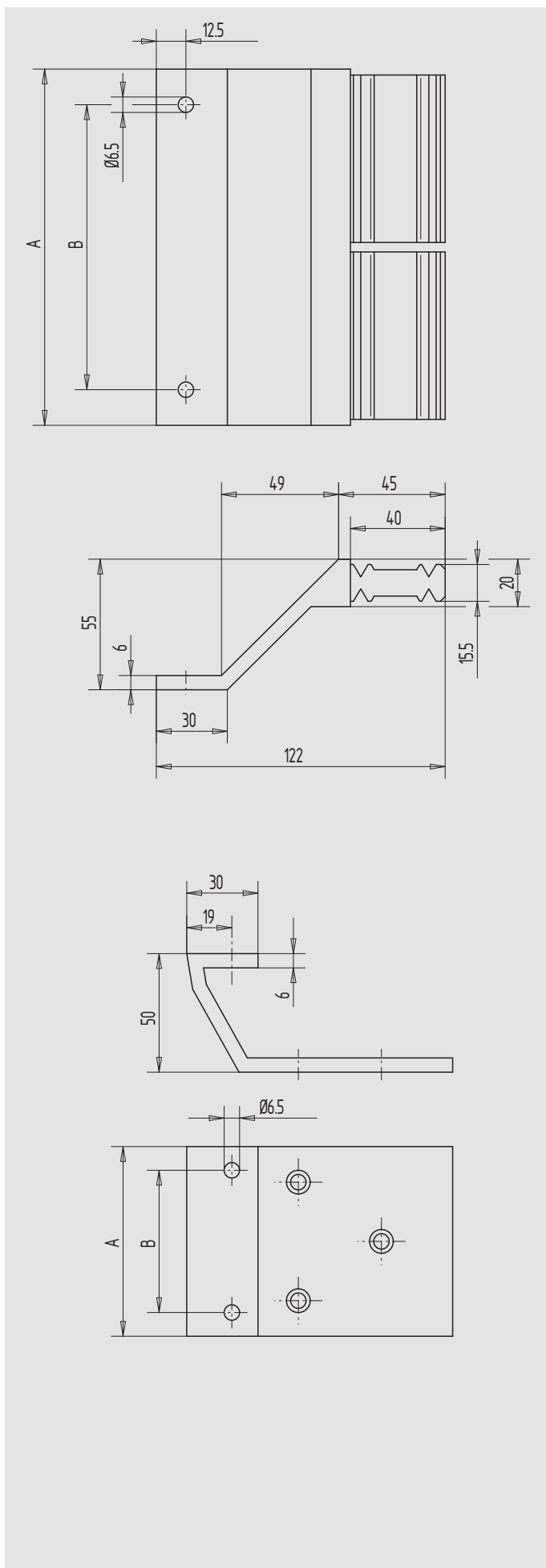

Aluminium console

■ angled

Art.-no.	A	B
08.503.0015.---	150	120
08.503.0018.---	180	150
08.503.0020.---	200	175

Surface codes	Material/Surface
---.105	Aluminium, bright
---.112	Aluminium, E4/C-0 anodized
---.114	Aluminium, E6/C-0 anodized
---.152	Aluminium, E4/C-34 anodized
---.255	Aluminium, RAL 9016 powder-coated

Information Consoles will always be delivered with 2 stainless steel flat springs.

Aluminium console

■ diagonal

Art.-no.	A	B
08.504.8060.---	80	60
08.504.1070.---	100	70
08.504.1210.---	120	100
08.504.1512.---	150	120
08.504.1715.---	175	150
08.504.2017.---	200	175
08.504.2520.---	250	200

Surface codes	Material/Surface
---.112	Aluminium, E4/C-0 anodized
---.152	Aluminium, E4/C-34 anodized
---.255	Aluminium, RAL 9016 powder-coated
---.299	Aluminium, special surface

1

2

3

4

5

6

7

8

9

i

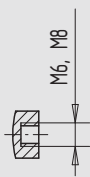
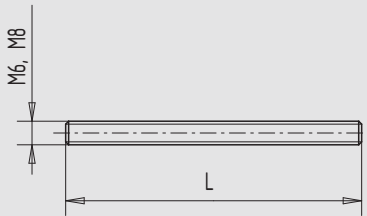
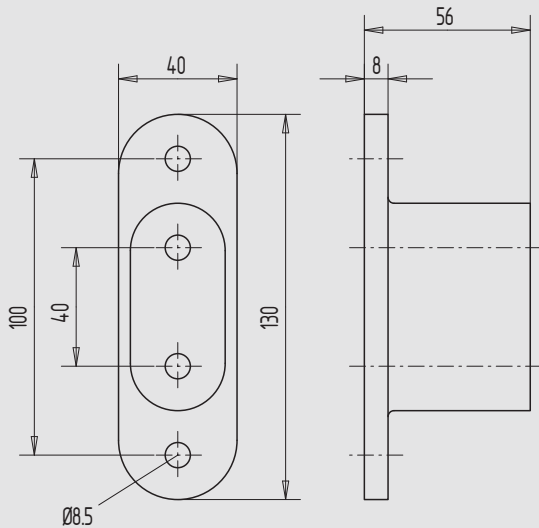

Block console

Art.-no.	Material/Surface
08.515.0000.112	Aluminium, E4/C-0 anodized
08.515.0000.152	Aluminium, E4/C-34 anodized
08.515.0000.255	Aluminium, RAL 9016 powder-coated
08.515.0000.299	Aluminium, special surface
08.515.0000.905	Bronze, nature

Threaded pin

Art.-no.	Dimension	Material/Surface
08.530.0665.010	M6 x 65	Steel, zinc-plated
08.530.0675.010	M6 x 75	Steel, zinc-plated
08.530.0675.405	M6 x 75	Stainless Steel V2A, bright
08.530.0610.010	M6 x 100	Steel, zinc-plated
08.530.0610.405	M6 x 100	Stainless Steel V2A, bright
08.530.0865.010	M8 x 65	Steel, zinc-plated
08.530.0875.010	M8 x 75	Steel, zinc-plated
08.530.0875.405	M8 x 75	Stainless Steel V2A, bright
08.530.0810.010	M8 x 100	Steel, zinc-plated
08.530.0810.405	M8 x 100	Stainless Steel V2A, bright

Bow nut

Art.-no.	Thread	Material/Surface
08.570.0600.112	M6	Aluminium, E4/C-0 anodized
08.570.0600.152	M6	Aluminium, E4/C-34 anodized
08.570.0600.255	M6	Aluminium, RAL 9016 powder-coated
08.570.0600.299	M6	Aluminium, special surface
08.570.0600.426	M6	Stainless Steel V2A, matt brushed
08.570.0600.905	M6	Bronze, nature
08.570.0800.112	M8	Aluminium, E4/C-0 anodized
08.570.0800.152	M8	Aluminium, E4/C-34 anodized
08.570.0800.255	M8	Aluminium, RAL 9016 powder-coated
08.570.0800.299	M8	Aluminium, special surface
08.570.0800.426	M8	Stainless Steel V2A, matt brushed
08.570.0800.905	M8	Bronze, nature

Glass holders with security pin

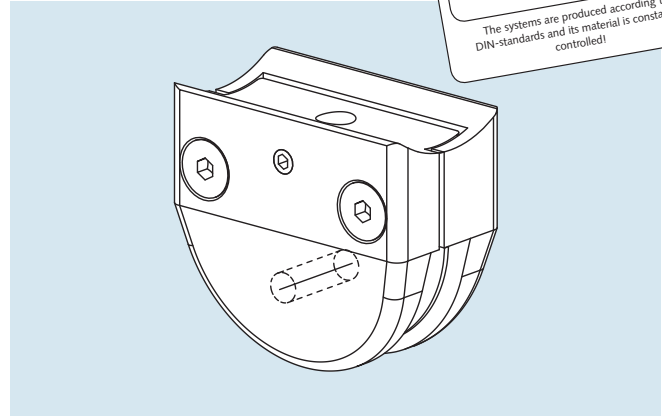
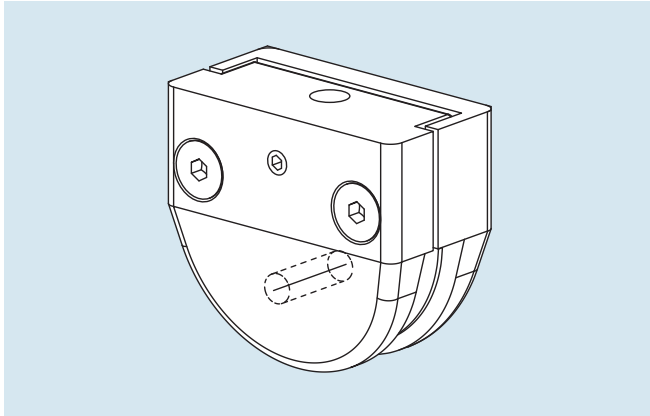
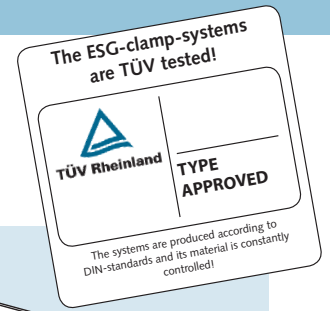

Clamp holders are available for rectangular- and round tubes.

Glass treatment

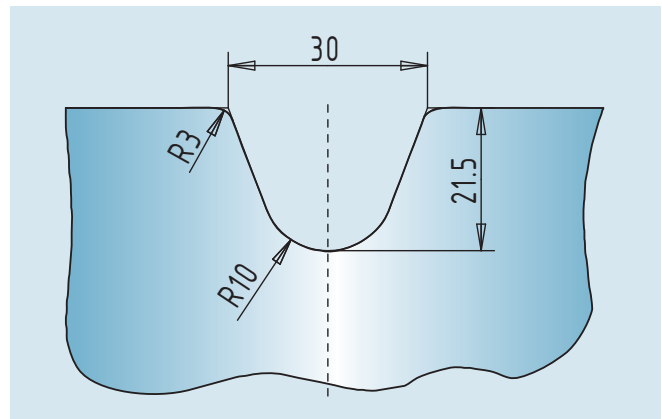
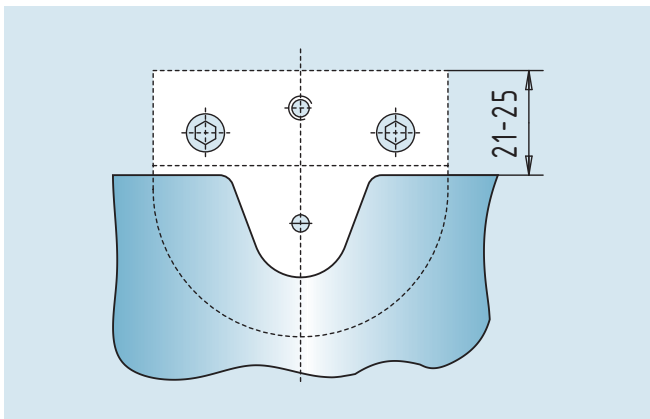

We suggest a security pin for sided ordered holders. Glass treatment is only necessary when use of security pins.

Information:
Please consider the guidelines for fall-securing glass.

Features:

- Usage from 6 to 12 mm glass thickness
- Stainless steel screws M6/M8
(Fastening torque 10/16 Nm)

1

2

3

4

5

6

7

8

9

i



1

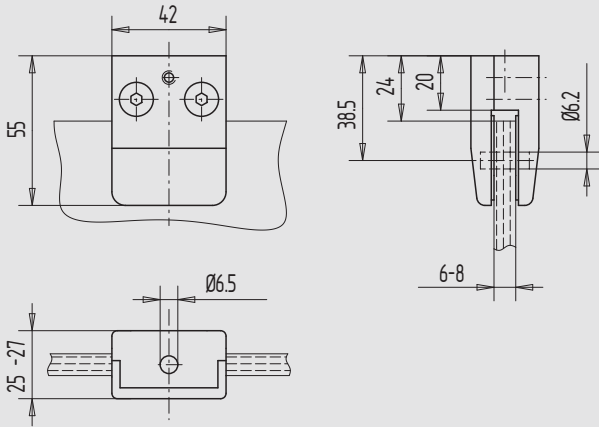

2

3

4

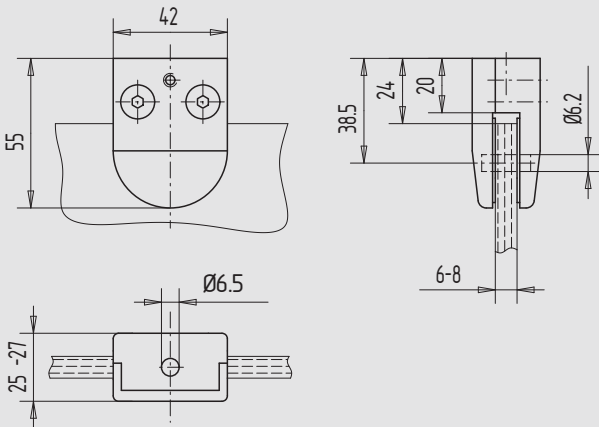

5

6

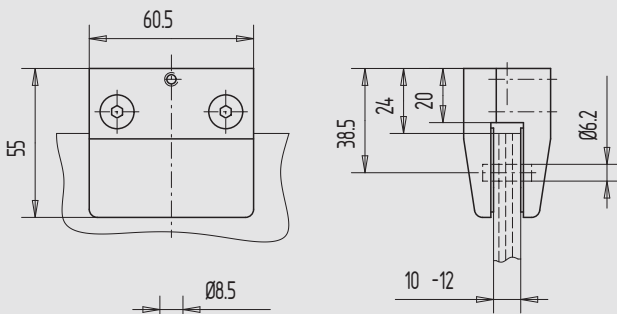

7

8

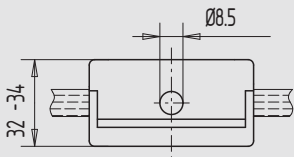

9

i

Glass holder, zinc die casting, straight support

- for 6 and 8 mm glass thickness
- angular form

Art.-no.	Material/Surface
08.600.0000.705	Zinc Die Casting, raw
08.600.0000.735	Zinc Die Casting, silver lacquered
08.600.0000.740	Zinc Die Casting, dark-bronze powder-coated
08.600.0000.755	Zinc Die Casting, RAL 9016 powder-coated
08.600.0000.770	Zinc Die Casting, RAL 9005 powder-coated
08.600.0000.773	Zinc Die Casting, stainless steel effect
08.600.0000.799	Zinc Die Casting, special surface

Glass holder, zinc die casting, straight support

- for 6 and 8 mm glass thickness
- rounded shape

Art.-no.	Material/Surface
08.601.0000.705	Zinc Die Casting, raw
08.601.0000.735	Zinc Die Casting, silver lacquered
08.601.0000.740	Zinc Die Casting, dark-bronze powder-coated
08.601.0000.755	Zinc Die Casting, RAL 9016 powder-coated
08.601.0000.770	Zinc Die Casting, RAL 9005 powder-coated
08.601.0000.773	Zinc Die Casting, stainless steel effect
08.601.0000.799	Zinc Die Casting, special surface

Glass holder, zinc die casting, straight support

- for 10 and 12 mm glass thickness
- angular shape

Art.-no.	Material/Surface
08.602.0000.705	Zinc Die Casting, raw
08.602.0000.735	Zinc Die Casting, silver lacquered
08.602.0000.740	Zinc Die Casting, dark-bronze powder-coated
08.602.0000.755	Zinc Die Casting, RAL 9016 powder-coated
08.602.0000.770	Zinc Die Casting, RAL 9005 powder-coated
08.602.0000.773	Zinc Die Casting, stainless steel effect
08.602.0000.799	Zinc Die Casting, special surface

Information All glass holders will basically be delivered with security pin.
(Glass treatment, see page 495)

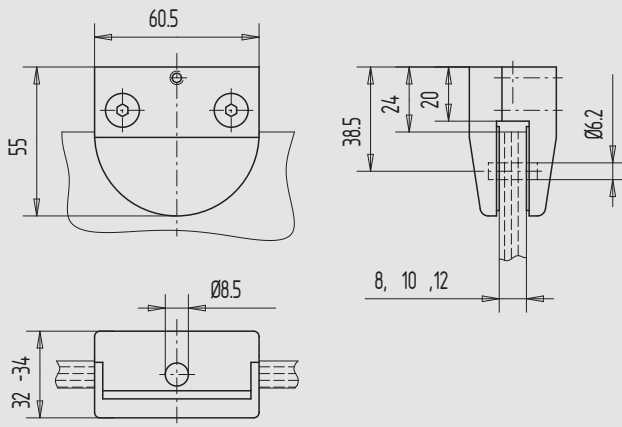

Glass holder, zinc die casting, straight support

- for 8 - 12 mm glass thickness
- rounded shape

Art.-no.	for glass thickness
08.603.0008.---	8
08.603.0010.---	10 und 12

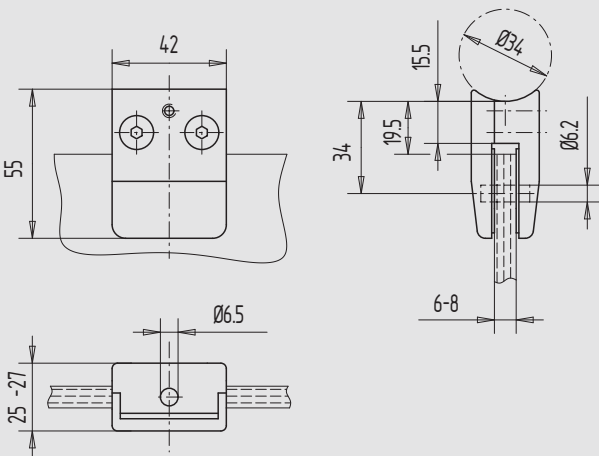

Glass holder, zinc die casting, arched support

- for 6 and 8 mm glass thickness
- angular shape
- for 34 mm tube diameter

Art.-no.
08.610.0000.---

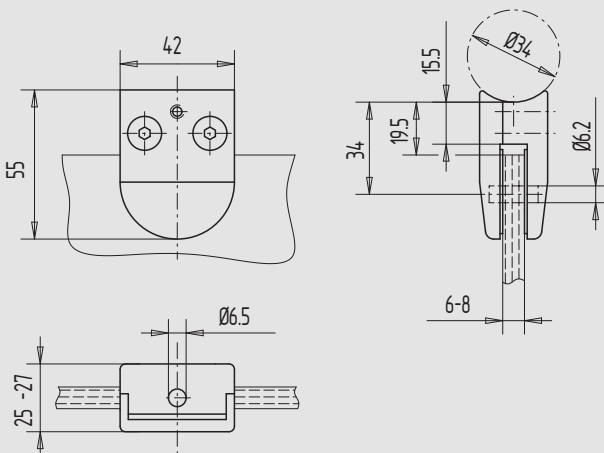

Glass holder, zinc die casting, arched support

- for 6 and 8 mm glass thickness
- rounded shape
- for 34 mm tube diameter

Art.-no.
08.611.0000.---

Surface codes	Material/Surface
---.705	Zinc Die Casting, raw
---.735	Zinc Die Casting, silver lacquered
---.740	Zinc Die Casting, dark-bronze powder-coated
---.755	Zinc Die Casting, RAL 9016 powder-coated
---.770	Zinc Die Casting, RAL 9005 powder-coated
---.773	Zinc Die Casting, stainless steel effect
---.799	Zinc Die Casting, special surface

Information
All glass holders will basicly be delivered with security pin. (Glass treatment, see page 495)

1

2

3

4

5

6

7

8

9

i

1
2
3
4
5
6
7
8
9
i

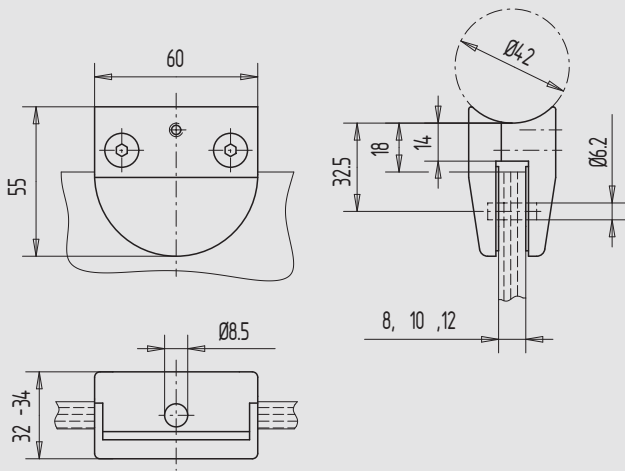

Glass holder, zinc die casting, arched support

- for 8 - 12 mm glass thickness
- rounded shape
- for 42 mm tube diameter

Art.-no.	for glass thickness
08.612.0008.---	8
08.612.0010.---	10 und 12

Surface codes	Material/Surface
---.705	Zinc Die Casting, raw
---.735	Zinc Die Casting, silver lacquered
---.740	Zinc Die Casting, dark-bronze powder-coated
---.755	Zinc Die Casting, RAL 9016 powder-coated
---.770	Zinc Die Casting, RAL 9005 powder-coated
---.773	Zinc Die Casting, stainless steel effect
---.799	Zinc Die Casting, special surface

Information All glass holders will basically be delivered with security pin.
(Glass treatment, see page 495)

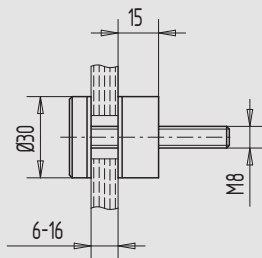

Glass holder, zinc die casting, straight support

- for 6 - 16 mm glass thickness, adjustable

Art.-no.	Material/Surface
08.620.0000.705	Zinc Die Casting, raw
08.620.0000.730	Zinc Die Casting, silver powder-coated
08.620.0000.755	Zinc Die Casting, RAL 9016 powder-coated
08.620.0000.770	Zinc Die Casting, RAL 9005 powder-coated
08.620.0000.772	Zinc Die Casting, matt chrome-plated

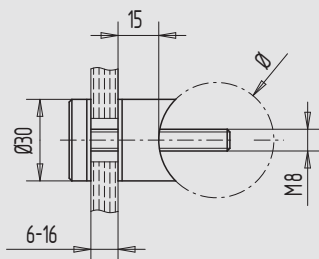

Glass holder, zinc die casting, arched support

- for 6 - 16 mm glass thickness, adjustable

Art.-no.	for tube-Ø
08.621.0033.---	33,7
08.621.0042.---	42,4
08.621.0048.---	48,3

Surface codes	Material/Surface
---.705	Zinc Die Casting, raw
---.730	Zinc Die Casting, silver powder-coated
---.755	Zinc Die Casting, RAL 9016 powder-coated
---.770	Zinc Die Casting, RAL 9005 powder-coated
---.772	Zinc Die Casting, matt chrome-plated

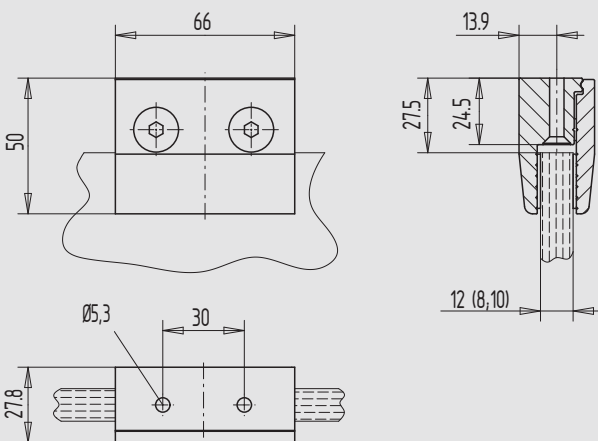
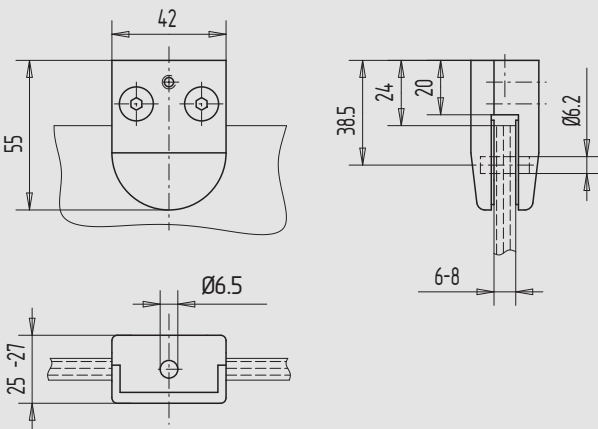
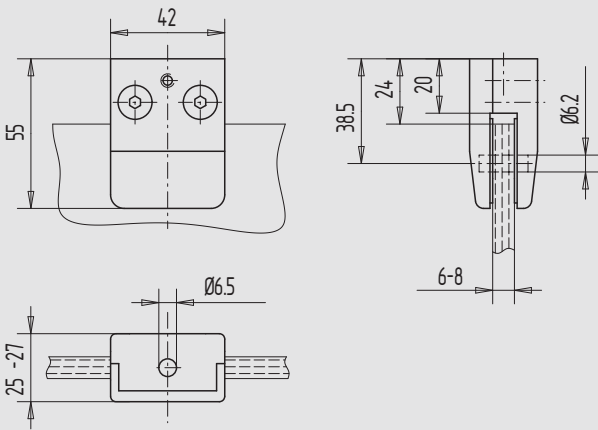

Glass holder, aluminium, straight support

- for 6 and 8 mm glass thickness
- angular shape

Art.-no.	Material/Surface
08.630.0000.112	Aluminium, E4/C-0 anodized
08.630.0000.152	Aluminium, E4/C-34 anodized
08.630.0000.157	Aluminium, E4/C-35 anodized

Glass holder, aluminium, straight support

- for 6 and 8 mm glass thickness
- rounded shape

Art.-no.	Material/Surface
08.631.0000.112	Aluminium, E4/C-0 anodized
08.631.0000.152	Aluminium, E4/C-34 anodized
08.631.0000.157	Aluminium, E4/C-35 anodized

Glass holder, aluminium, straight support

- angular shape
- without security pin

Art.-no.	for glass thickness	Material/Surface
08.632.0008.112	8	Aluminium, E4/C-0 anodized
08.632.0008.152	8	Aluminium, E4/C-34 anodized
08.632.0008.157	8	Aluminium, E4/C-35 anodized
08.632.0010.112	10	Aluminium, E4/C-0 anodized
08.632.0010.152	10	Aluminium, E4/C-34 anodized
08.632.0010.157	10	Aluminium, E4/C-35 anodized
08.632.0012.112	12	Aluminium, E4/C-0 anodized
08.632.0012.152	12	Aluminium, E4/C-34 anodized
08.632.0012.157	12	Aluminium, E4/C-35 anodized

Information All glass holders will basically be delivered with security pin.
(Glass treatment, see page 495)



1

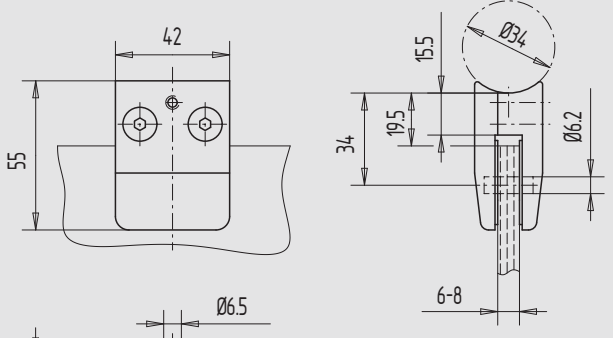

2

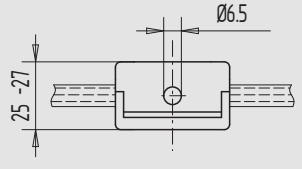

3

4

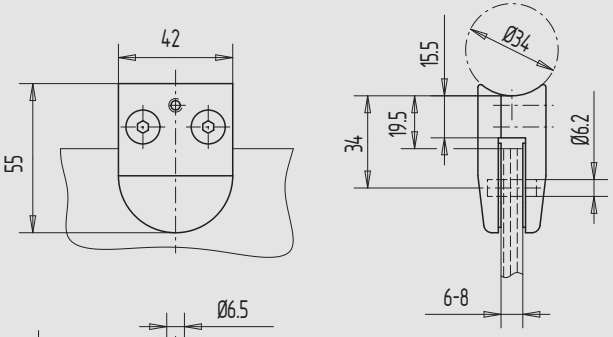

5

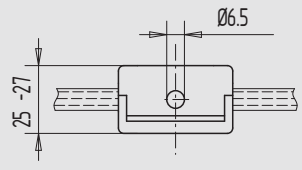

6

7

8

9

i

Glass holder, aluminium, arched support

- for 6 and 8 mm glass thickness
- angular shape
- for 34 mm tube diameter

Art.-no.	Material/Surface
08.633.0000.112	Aluminium, E4/C-0 anodized
08.633.0000.152	Aluminium, E4/C-34 anodized
08.633.0000.157	Aluminium, E4/C-35 anodized

Glass holder, aluminium, arched support

- for 6 and 8 mm glass thickness
- rounded shape
- for 34 mm tube diameter

Art.-no.	Material/Surface
08.634.0000.112	Aluminium, E4/C-0 anodized
08.634.0000.152	Aluminium, E4/C-34 anodized
08.634.0000.157	Aluminium, E4/C-35 anodized

Information All glass holders will basically be delivered with security pin.
(Glass treatment, see [page 495](#))

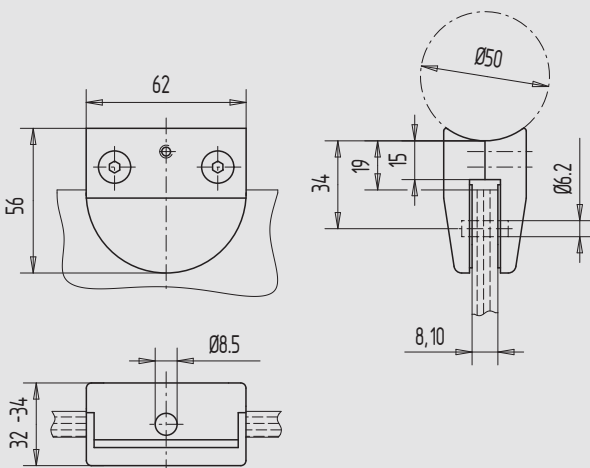
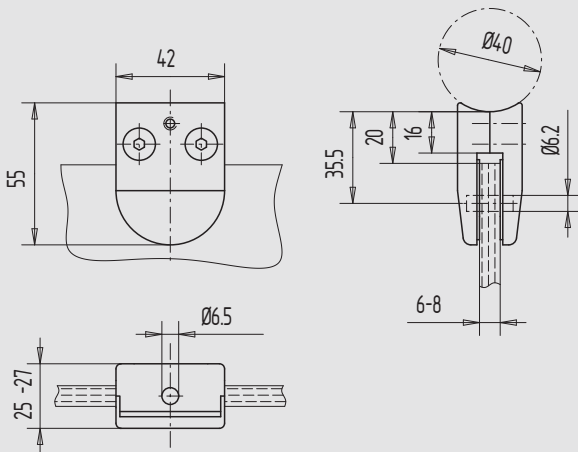
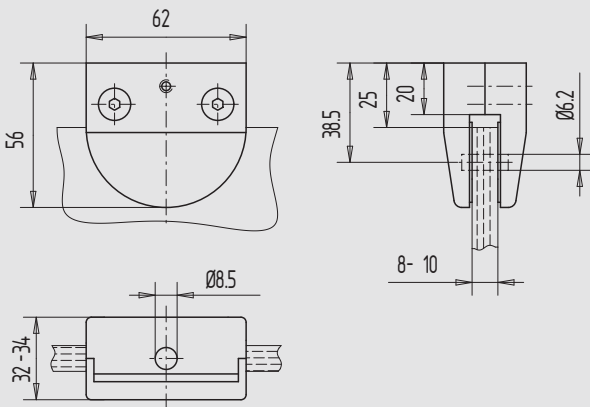
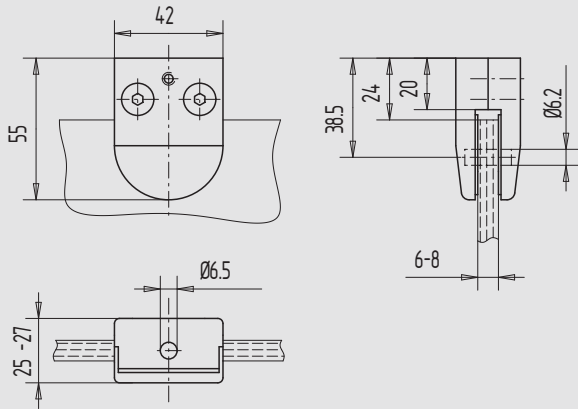

Glass holder, brass/stainless steel (V2A), straight support

- for 6 and 8 mm glass thickness
- rounded shape

Art.-no.	Material/Surface
08.670.0000.318	Brass, polished, with clear coat
08.670.0000.328	Brass, matt brushed, with clear coat
08.670.0000.416	Stainless Steel V2A, polished
08.670.0000.426	Stainless Steel V2A, matt brushed

Glass holder, brass/stainless steel (V2A), straight support

- for 8 and 10 mm glass thickness
- rounded shape

Art.-no.	Material/Surface
08.671.0000.318	Brass, polished, with clear coat
08.671.0000.328	Brass, matt brushed, with clear coat
08.671.0000.416	Stainless Steel V2A, polished
08.671.0000.426	Stainless Steel V2A, matt brushed

Glass holder, brass/stainless steel (V2A), arched support

- for 6 and 8 mm glass thickness
- rounded shape
- for 40 mm tube diameter

Art.-no.	Material/Surface
08.675.0000.318	Brass, polished, with clear coat
08.675.0000.328	Brass, matt brushed, with clear coat
08.675.0000.416	Stainless Steel V2A, polished
08.675.0000.426	Stainless Steel V2A, matt brushed

Glass holder, brass/stainless steel (V2A), arched support

- for 8 and 10 mm glass thickness
- rounded shape
- for 50 mm tube diameter

Art.-no.	Material/Surface
08.676.0000.318	Brass, polished, with clear coat
08.676.0000.328	Brass, matt brushed, with clear coat
08.676.0000.416	Stainless Steel V2A, polished
08.676.0000.426	Stainless Steel V2A, matt brushed

Information All glass holders will basically be delivered with security pin.
(Glass treatment, see page 495)

1

2

3

4

5

6

7

8

9

i



1

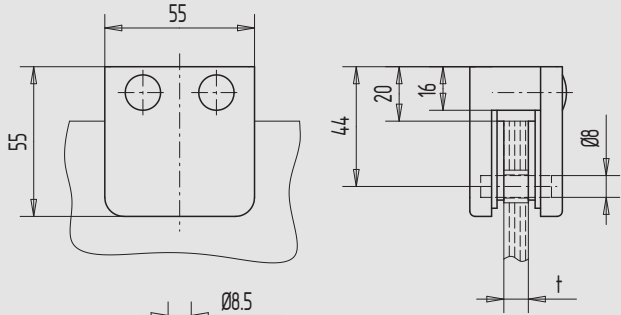

2

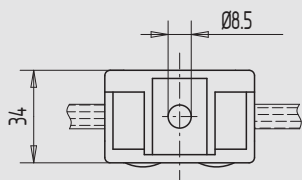

3

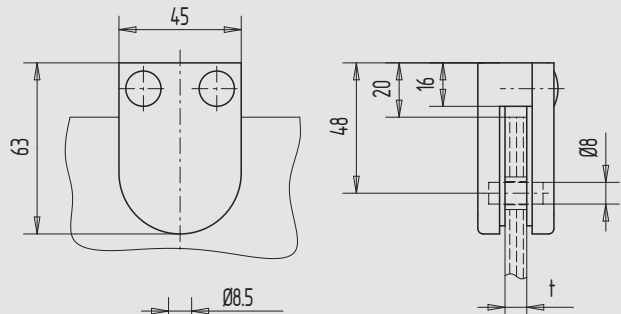

4

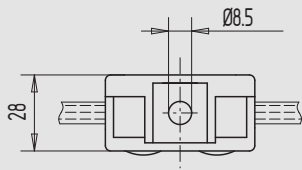

5

6

7

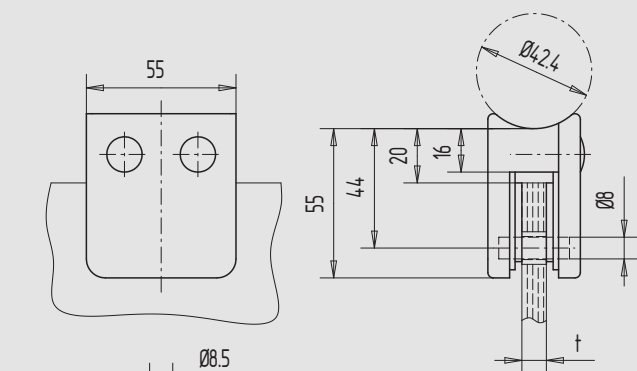

8

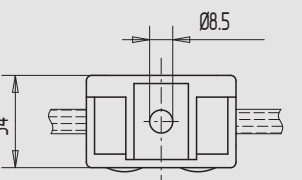

9

i

Glass holder, stainless steel (V4A), straight support

- angular shape

Art.-no.	for laminated security glass	Material/Surface
08.680.0008.428	8,76	Stainless Steel V4A, matt brushed
08.680.0010.428	10,76	Stainless Steel V4A, matt brushed
08.680.0012.428	12,76	Stainless Steel V4A, matt brushed

Glass holder, stainless steel (V4A), straight support

- rounded shape

Art.-no.	for laminated security glass	Material/Surface
08.681.0006.428	6,76	Stainless Steel V4A, matt brushed
08.681.0008.428	8,76	Stainless Steel V4A, matt brushed

Glass holder, stainless steel (V4A), arched support

- angular shape
- for 42,4 mm tube diameter

Art.-no.	for laminated security glass	Material/Surface
08.685.0008.428	8,76	Stainless Steel V4A, matt brushed
08.685.0010.428	10,76	Stainless Steel V4A, matt brushed
08.685.0012.428	12,76	Stainless Steel V4A, matt brushed

Information All glass holders will basically be delivered with security pin. (Glass treatment, see page 495)

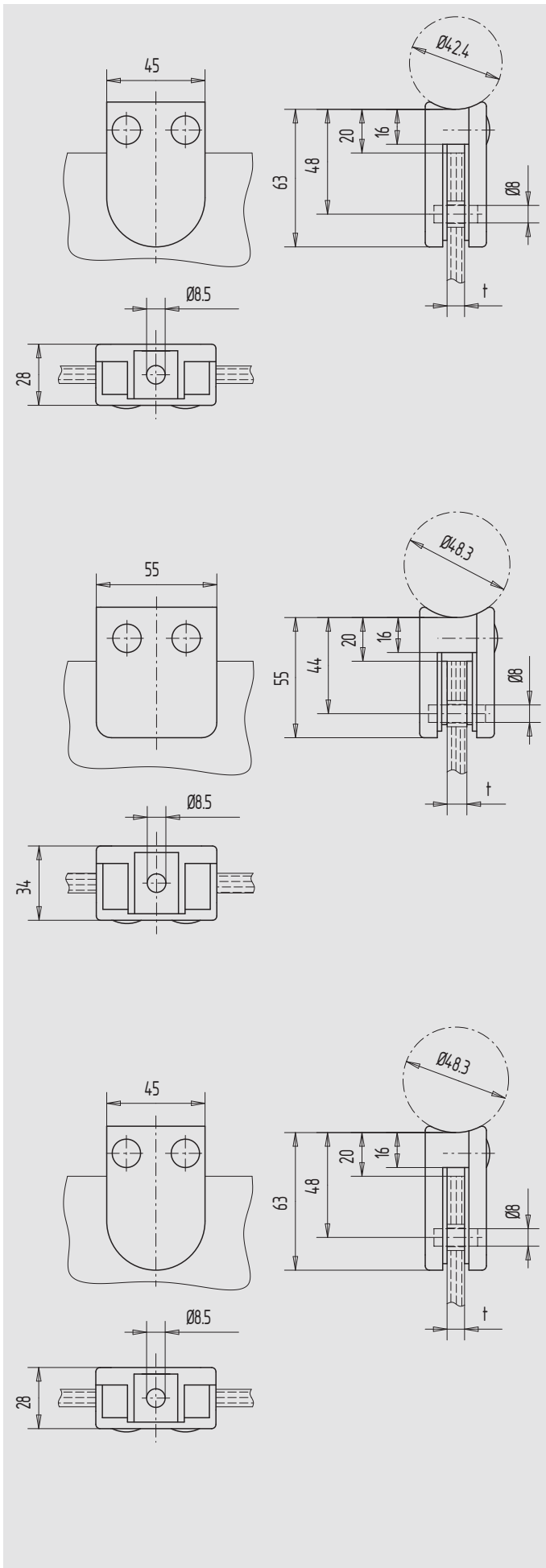

Glass holder, stainless steel (V4A), arched support

- rounded shape
- for 42,4 mm tube diameter

Art.-no.	for laminated security glass	Material/Surface
08.686.0006.428	6,76	Stainless Steel V4A, matt brushed
08.686.0008.428	8,76	Stainless Steel V4A, matt brushed

Glass holder, stainless steel (V4A), arched support

- angular shape
- for 48,3 mm tube diameter

Art.-no.	for laminated security glass	Material/Surface
08.687.0008.428	8,76	Stainless Steel V4A, matt brushed
08.687.0010.428	10,76	Stainless Steel V4A, matt brushed
08.687.0012.428	12,76	Stainless Steel V4A, matt brushed

Glass holder, stainless steel (V4A), arched support

- rounded shape
- for 48,3 mm tube diameter

Art.-no.	for laminated security glass	Material/Surface
08.688.0006.428	6,76	Stainless Steel V4A, matt brushed
08.688.0008.428	8,76	Stainless Steel V4A, matt brushed

Information All glass holders will basically be delivered with security pin.
(Glass treatment, see page 495)

1

2

3

4

5

6

7

8

9

i



1

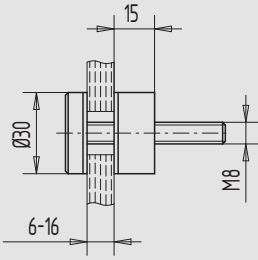

2

3

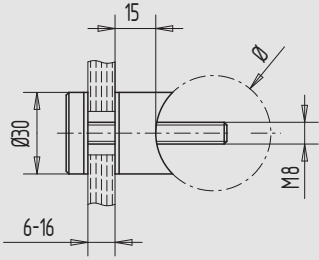

4

5

6

7

8

9

i

Glass holder, stainless steel (V4A), straight support

- for 6 - 16 mm glass thickness
- glass drilling hole 16 mm diameter, adjustable

Art.-no.	Material/Surface
08.695.0000.428	Stainless Steel V4A, matt brushed

Glass holder, stainless steel (V4A), arched support

- for 6 - 16 mm glass thickness
- glass drilling hole 16 mm diameter, adjustable

Art.-no.	for tube-Ø	Material/Surface
08.696.0042.428	42,4	Stainless Steel V4A, matt brushed
08.696.0048.428	48,3	Stainless Steel V4A, matt brushed

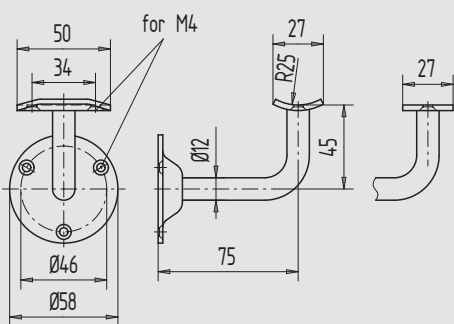
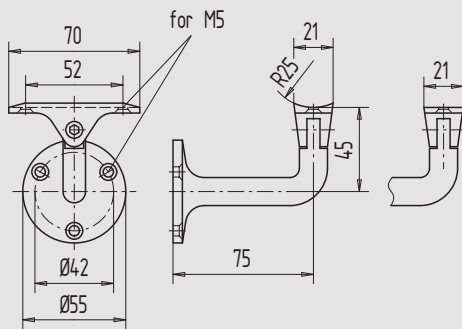
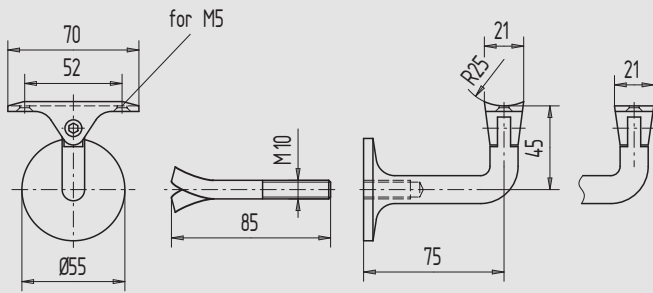

Hand rail support, rotatable support

- with anchor bolt

Art.-no.	Support	Material/Surface
08.700.0010.035	domed	Steel, silver lacquered
08.700.0010.112	domed	Aluminium, E4/C-0 anodized
08.700.0010.152	domed	Aluminium, E4/C-34 anodized
08.700.0010.318	domed	Brass, polished, with clear coat
08.700.0020.035	flat	Steel, silver lacquered
08.700.0020.112	flat	Aluminium, E4/C-0 anodized
08.700.0020.152	flat	Aluminium, E4/C-34 anodized
08.700.0020.318	flat	Brass, polished, with clear coat

Hand rail support, rotatable support

- with 3 sunk fixing holes to screw-on

Art.-no.	Support	Material/Surface
08.701.0010.035	domed	Steel, silver lacquered
08.701.0010.112	domed	Aluminium, E4/C-0 anodized
08.701.0010.152	domed	Aluminium, E4/C-34 anodized
08.701.0010.318	domed	Brass, polished, with clear coat
08.701.0010.328	domed	Brass, matt brushed, with clear coat
08.701.0020.035	flat	Steel, silver lacquered
08.701.0020.112	flat	Aluminium, E4/C-0 anodized
08.701.0020.152	flat	Aluminium, E4/C-34 anodized
08.701.0020.318	flat	Brass, polished, with clear coat
08.701.0020.328	flat	Brass, matt brushed, with clear coat

Hand rail support, fixed support

- with 3 sunk fixing holes to screw-on

Art.-no.	Support
08.702.0010.---	domed
08.702.0020.---	flat

Surface codes	Material/Surface
---.010	Steel, zinc-plated
---.020	Steel, black lacquered
---.035	Steel, silver lacquered
---.099	Steel, special surface
---.318	Brass, polished, with clear coat
---.328	Brass, matt brushed, with clear coat
---.416	Stainless Steel V2A, polished
---.426	Stainless Steel V2A, matt brushed



1

2

3

4

5

6

7

8

9

i

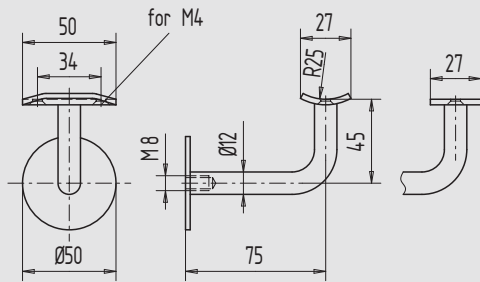

Hand rail support, fixed support

■ with anchor bolt

Art.-no.	Support
08.703.0010.---	domed
08.703.0020.---	flat

Surface codes	Material/Surface
---.010	Steel, zinc-plated
---.020	Steel, black lacquered
---.035	Steel, silver lacquered
---.099	Steel, special surface
---.318	Brass, polished, with clear coat
---.328	Brass, matt brushed, with clear coat
---.416	Stainless Steel V2A, polished
---.426	Stainless Steel V2A, matt brushed

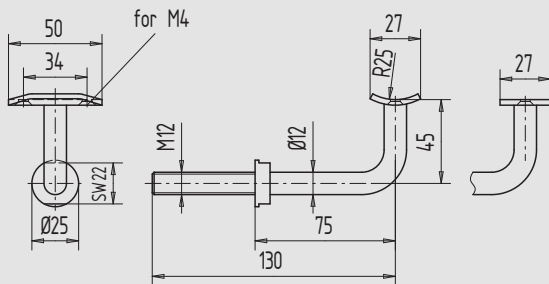

Hand rail support, fixed support

■ with thread M12 to anchor

Art.-no.	Support	Material/Surface
08.704.0010.010	domed	Steel, zinc-plated
08.704.0010.020	domed	Steel, black lacquered
08.704.0010.035	domed	Steel, silver lacquered
08.704.0010.099	domed	Steel, special surface
08.704.0010.416	domed	Stainless Steel V2A, polished
08.704.0010.426	domed	Stainless Steel V2A, matt brushed
08.704.0020.010	flat	Steel, zinc-plated
08.704.0020.020	flat	Steel, black lacquered
08.704.0020.035	flat	Steel, silver lacquered
08.704.0020.099	flat	Steel, special surface
08.704.0020.416	flat	Stainless Steel V2A, polished
08.704.0020.426	flat	Stainless Steel V2A, matt brushed

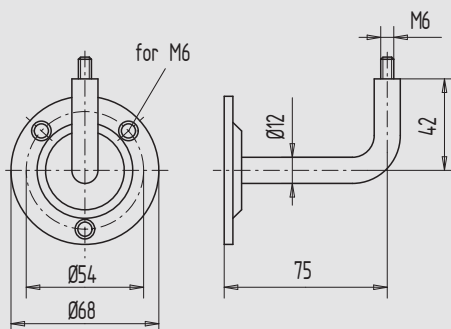
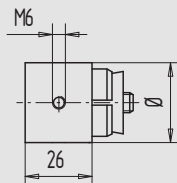
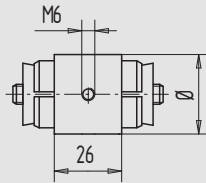
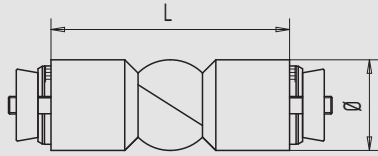

Stainless steel spherical joint for hand rails

- 3D-adjustable 90° - 180°
- clamping system

Art.-no.	for Ø	L	Material/Surface
08.800.0035.426	35,0 x 1,5	105	Stainless Steel V2A, matt brushed
08.800.0040.426	40,0 x 2,0	110	Stainless Steel V2A, matt brushed
08.800.0042.426	42,4 x 2,0	110	Stainless Steel V2A, matt brushed

Stainless steel connection collar for hand rails

- drilling hole for hand rail support (M6)
- clamping system

Art.-no.	for Ø	Material/Surface
08.801.0035.426	35,0 x 1,5	Stainless Steel V2A, matt brushed
08.801.0040.426	40,0 x 2,0	Stainless Steel V2A, matt brushed
08.801.0042.426	42,4 x 2,0	Stainless Steel V2A, matt brushed

Stainless steel end cap for hand rails

Art.-no.	for Ø	Material/Surface
08.802.0035.426	35,0 x 1,5	Stainless Steel V2A, matt brushed
08.802.0040.426	40,0 x 2,0	Stainless Steel V2A, matt brushed
08.802.0042.426	42,4 x 2,0	Stainless Steel V2A, matt brushed

Stainless steel end-collar for hand rails

- drilling hole for hand rail support (M6)
- clamping system

Art.-no.	for Ø	Material/Surface
08.803.0035.426	35,0 x 1,5	Stainless Steel V2A, matt brushed
08.803.0040.426	40,0 x 2,0	Stainless Steel V2A, matt brushed
08.803.0042.426	42,4 x 2,0	Stainless Steel V2A, matt brushed

Stainless steel hand rail support

- to be mounted with screws
- thread M6 for tube and muffle

Art.-no.	Material/Surface
08.804.0000.426	Stainless Steel V2A, matt brushed

1

2

3

4

5

6

7

8

9

i



1

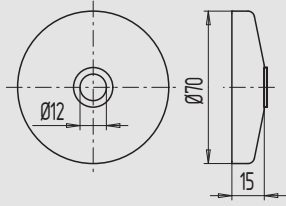

2

3

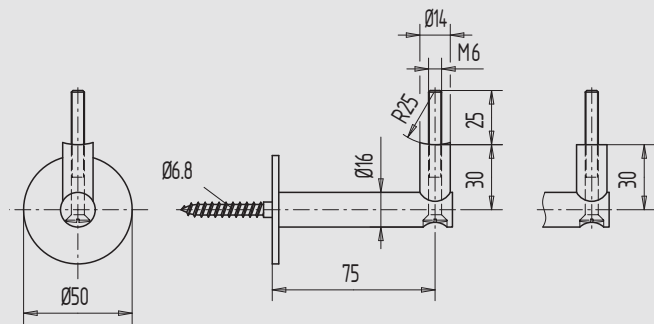

4

5

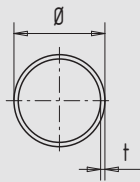

6

7

8

9

i

Stainless steel cover cap

Art.-no.	Material/Surface
08.805.0000.426	Stainless Steel V2A, matt brushed

Accessories:

Stainless steel hand rail support [page 507](#)

Stainless steel hand rail support

- with anchor bolt
- thread M6 for tube or muffle

Art.-no.	Support	Material/Surface
08.806.0010.426	domed	Stainless Steel V2A, matt brushed
08.806.0020.426	flat	Stainless Steel V2A, matt brushed

Stainless steel tube

Art.-no.	Ø	t	L	Material/Surface
08.807.0035.426	35	1,5	6000	Stainless Steel V2A, matt brushed
08.807.0040.426	40	2	6000	Stainless Steel V2A, matt brushed
08.807.0042.426	42,4	2	6000	Stainless Steel V2A, matt brushed